

NOTE: Some components in this section are not shown for clarity.

Step 1: Remove the Flap Motor Cover Assembly. See Page 42-04, Figure 1.

Step 2: Disconnect all Linear Actuator wiring and position sensor equipment if installed.

Step 3: Remove the hardware attaching the existing Linear Actuator to the F-01466-L & -R Flap Motor Brackets and to the WD-1013 Flap Crank, then remove the Linear Actuator. See Figure 1 detail views.

NOTE: Use care when drilling out rivets to allow holes to be reused. Refer to Section 5 for more information.

Step 4: Remove the rivets attaching the F-01466-L & -R Flap Motor Brackets. See Figure 2.

Remove the brackets and discard.

OP-65: RV-14 FLAP MOTOR RETROFIT

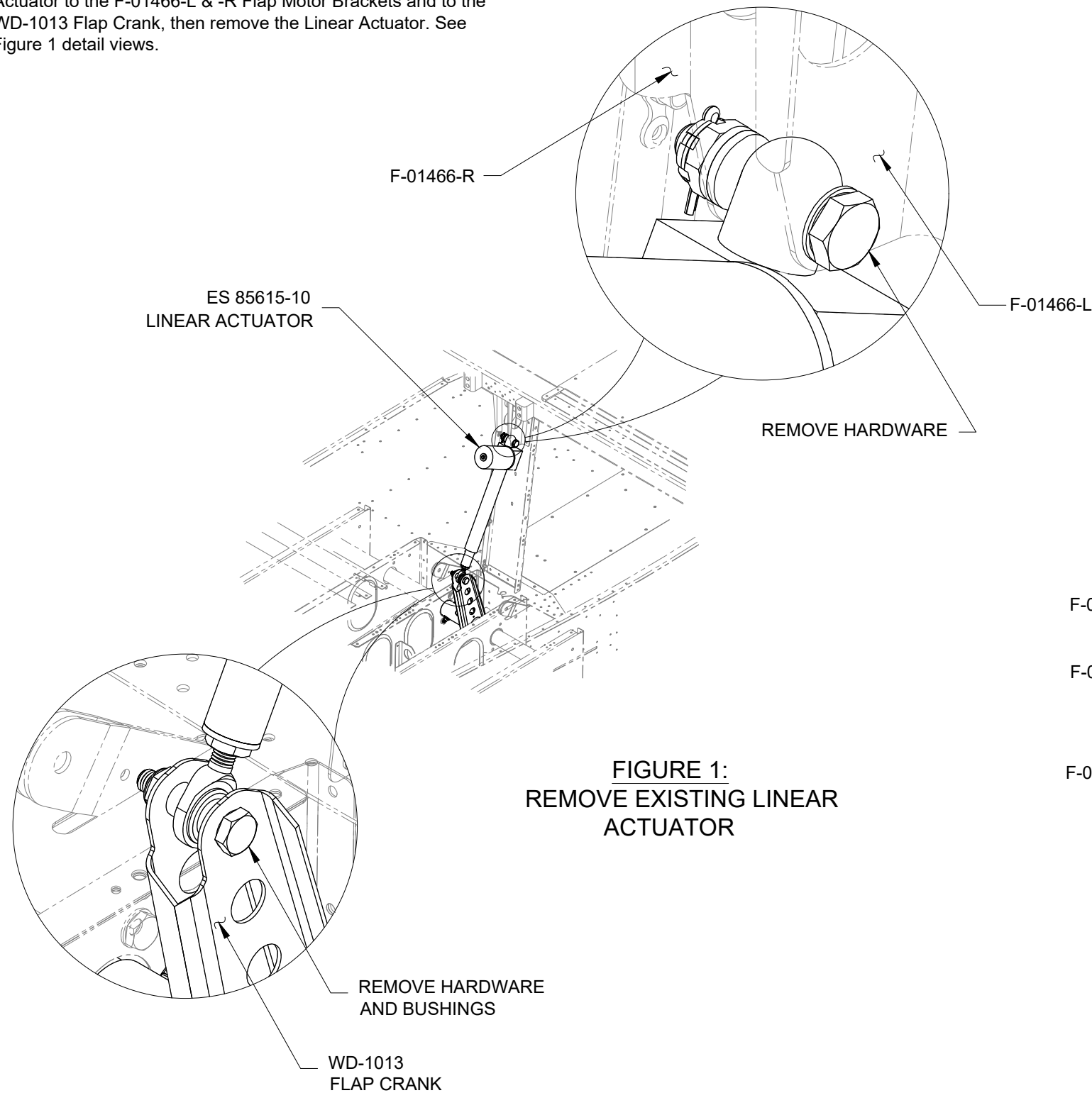

**FIGURE 1:
REMOVE EXISTING LINEAR
ACTUATOR**

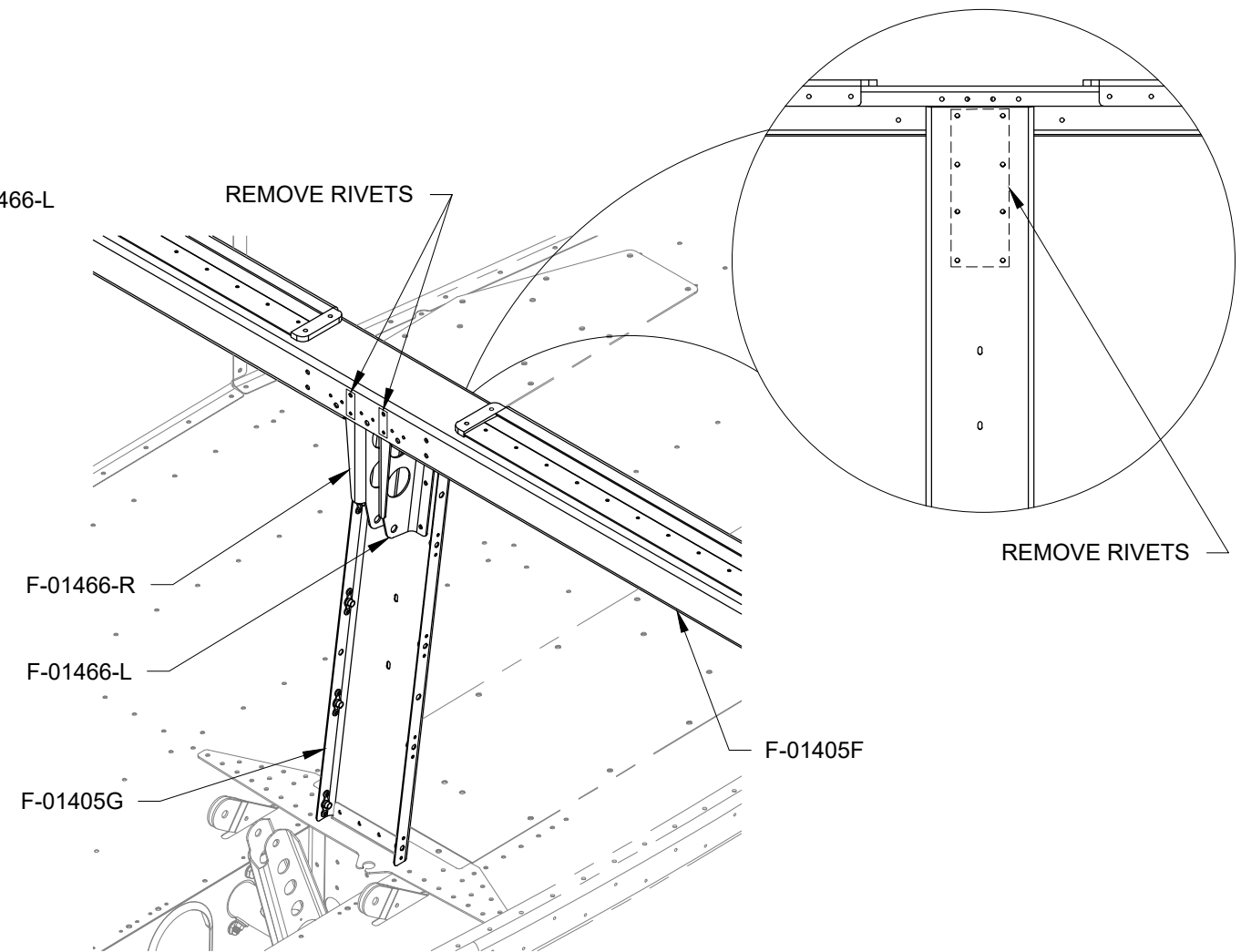

**FIGURE 2:
REMOVE FLAP MOTOR BRACKETS
(DETAIL VIEW SHOWN FROM BAGGAGE AREA)**

Step 1: Widened the gap in the flange of the F-01405F Mid Fuse Brace. As shown in Figure 1. Check that the F-01466-L-2 & -R-2 Flap Motor Brackets and the F-01405F Mid Fuse Brace no longer interfere. Check fitment of the flap motor brackets by Clecoing them in place. See Figure 2.

Step 2: Rivet the F-01466-L-2 & -R-2 Flap Motor Brackets to the F-01405G Flap Motor Channel as shown in Figure 2. The rivet call-outs shown for F-01466-R-2 also apply to F-01466-L-2.

Pull the flap motor channel aft as required when installing the F-01466-L-2 & -R-2 Flap Motor Brackets.

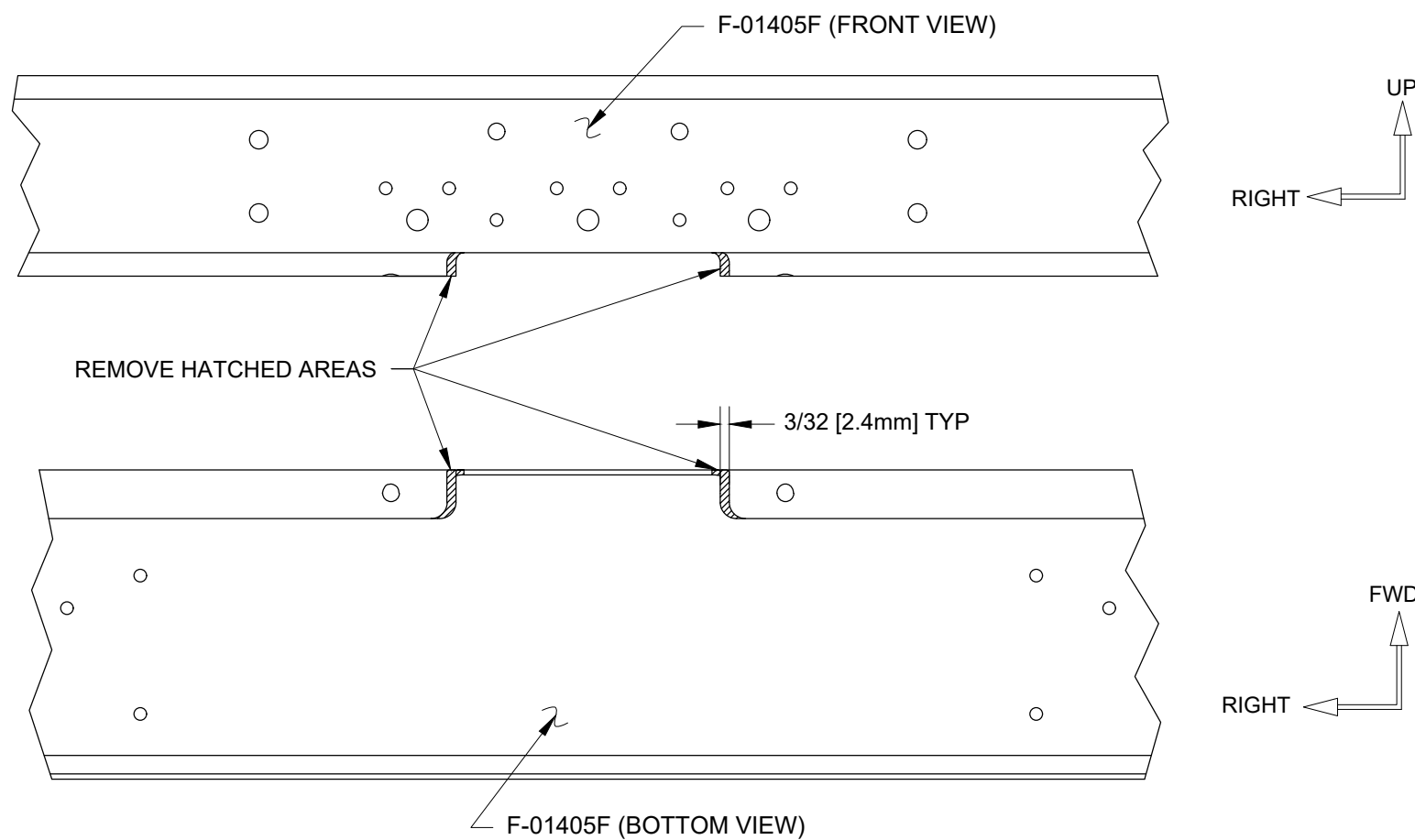

FIGURE 1: F-01405F FLANGE GAP

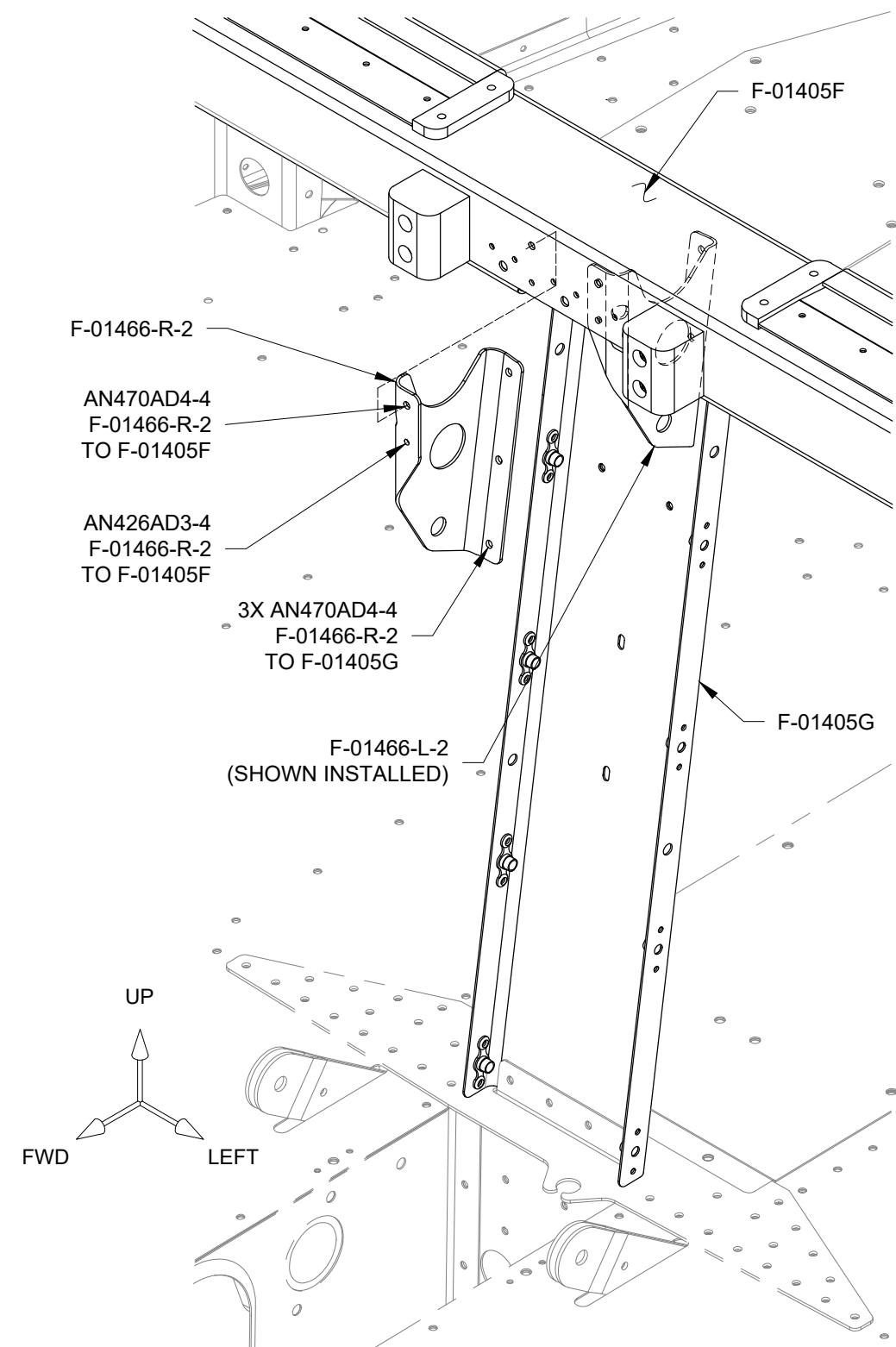
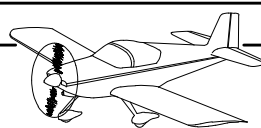

FIGURE 2: INSTALL FLAP MOTOR BRACKETS



Step 1: Install the jam nut onto the rod end bearing then add a drop of Blue Loctite to the rod end threads and install the rod end into the ES-FA-PA-270-12-5 Flap Motor shaft as shown in Figure 1.

WARNING: At least seven rod end bearing threads must engage the flap motor shaft.

Step 2: With the flap motor shaft extended to its maximum length, adjust the rod end bearing to achieve the center to center distance shown in Figure 2. Tighten the jam nut against the face of the flap motor shaft while keeping the rod end bearing face vertical as shown in Figure 2.

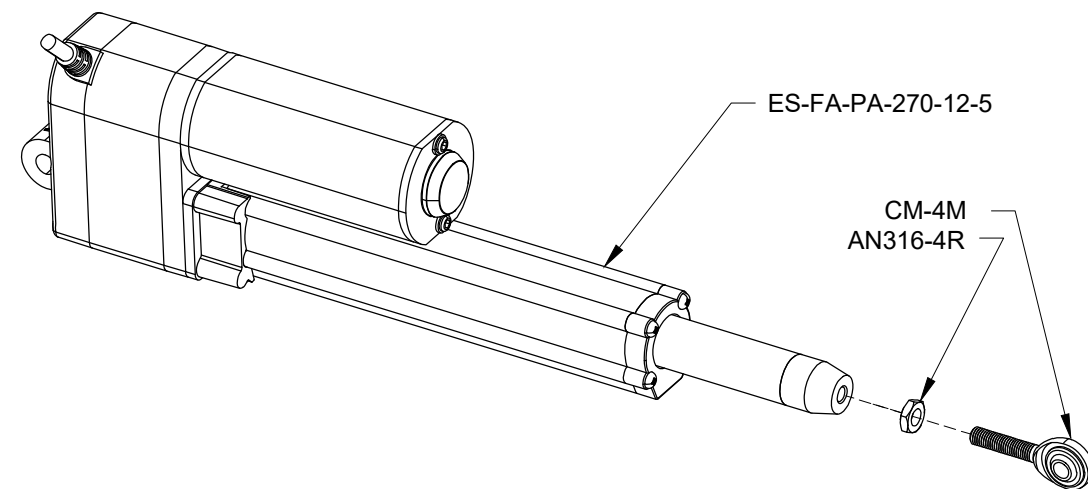

FIGURE 1: ROD END BEARING INSTALLATION

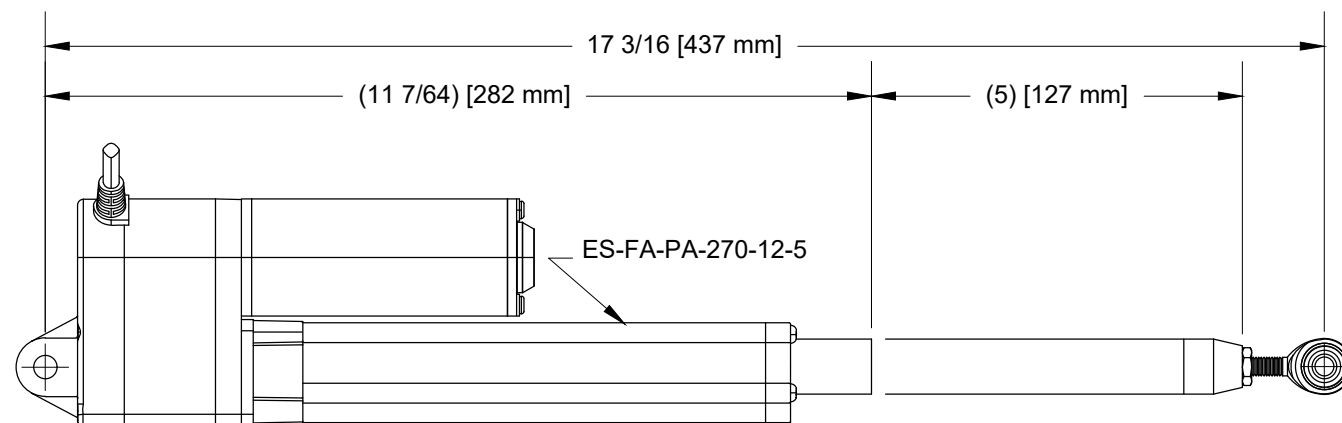

FIGURE 2: FLAP MOTOR EXTENDED & RETRACTED LENGTHS

Step 3: Apply a small amount of wheel bearing grease to the bolt shank, as shown in Figure 3. Bolt the ES-FA-PA-270-12-5 Flap Motor lug to the F-01466-L-2 & -R-2 Flap Motor Brackets using the hardware called out in Figure 3. Tighten the castle nut just enough to remove end play but not so much as to add friction. Install the cotter pin oriented as shown in Figure 4. Incorrect orientation will result in interference between the cotter pin and the Flap Motor Cover Assembly See Page 65-05, Figure 1.

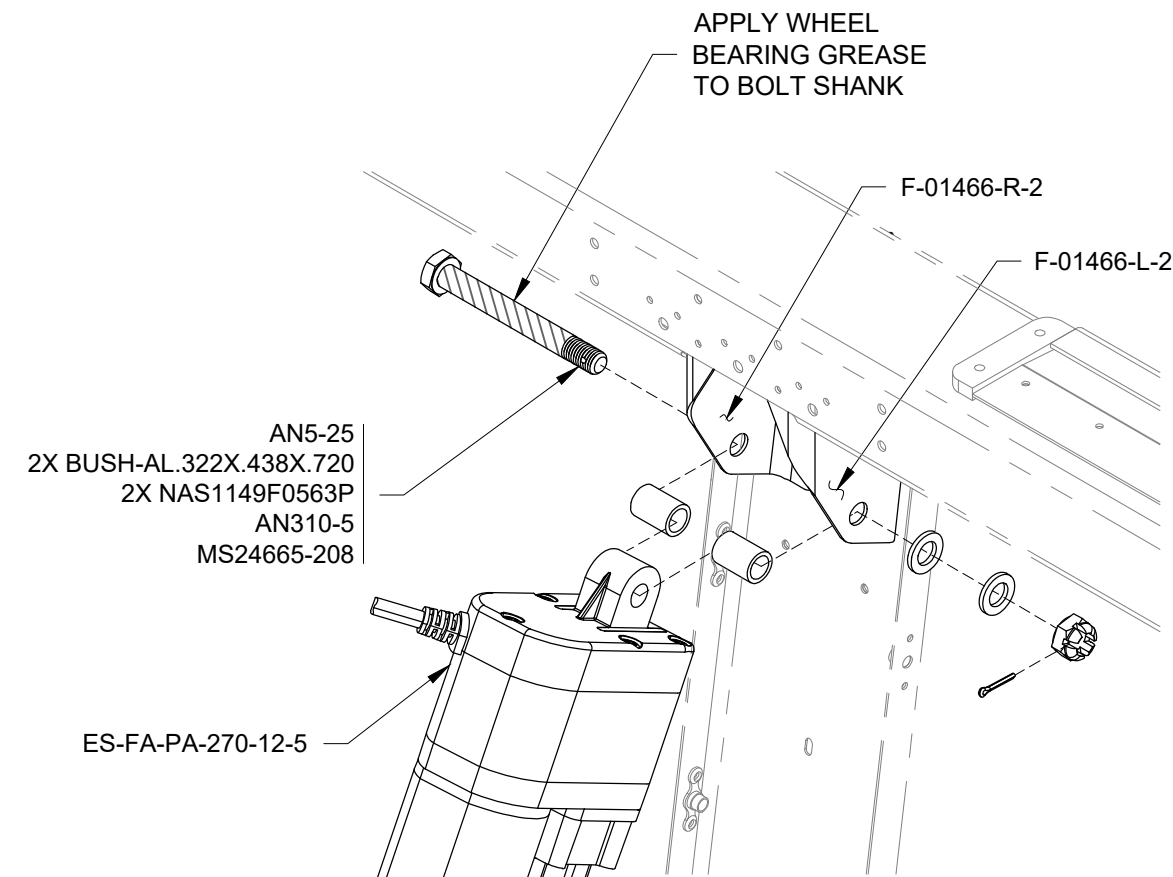

FIGURE 3: UPPER FLAP MOTOR ATTACHMENT

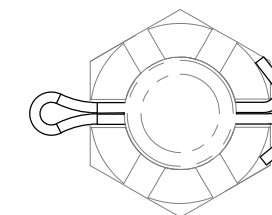

FIGURE 4: COTTER PIN INSTALLATION

Step 1: Bolt the ES-FA-PA-270-12-5 Flap Motor rod end bearing to the WD-1013A Flap Crank using the hardware called out in Figure 1. Refer to Section 5 for proper nut torque.

Step 2: Rivet the F-01445A-1 Flap Motor Cover Front to the F-01445B-L-1 & -R-1 Flap Motor Cover Sides with the hardware called out in Figure 2. This is now the Flap Motor Cover Assembly.

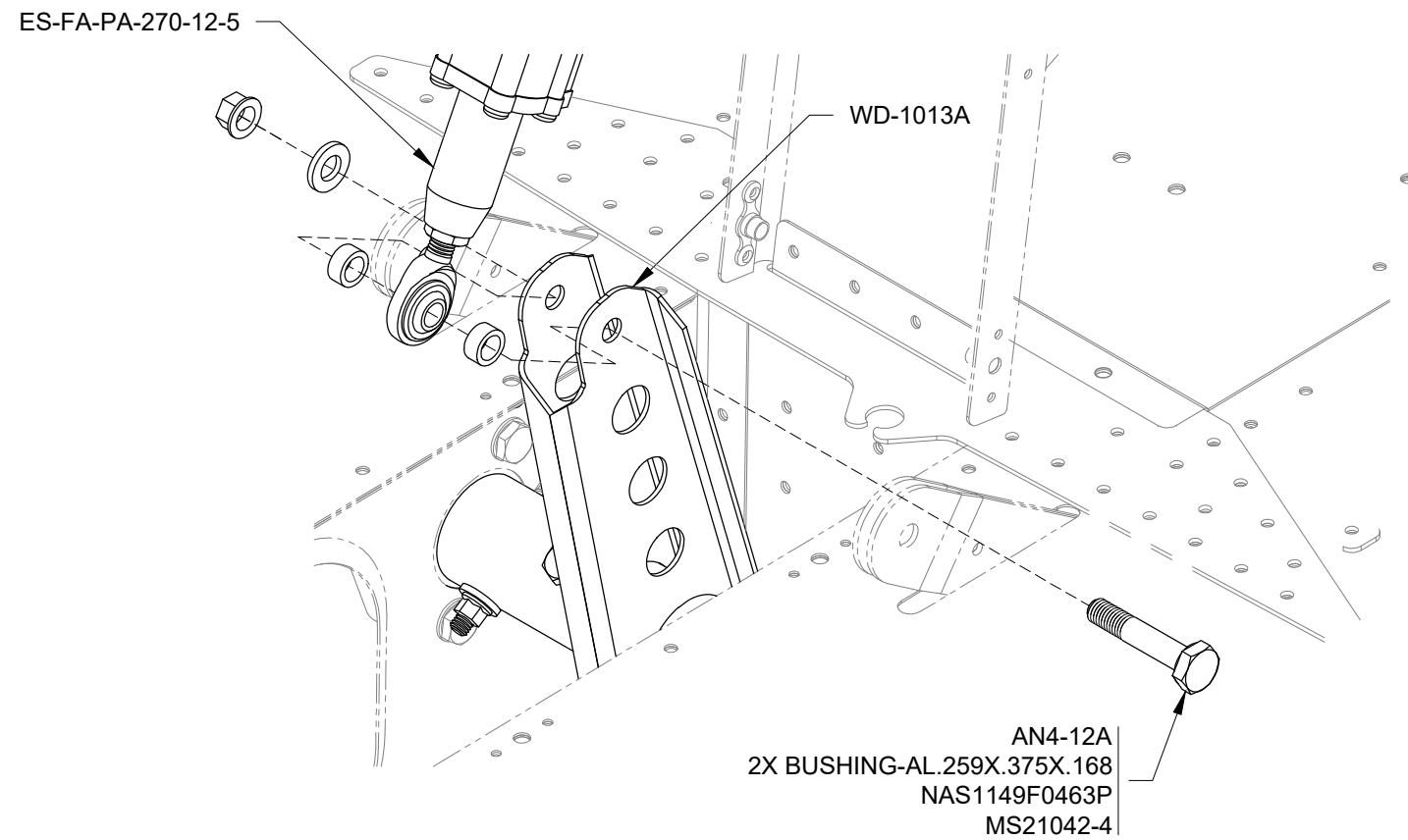

FIGURE 1: LOWER FLAP MOTOR ATTACHMENT

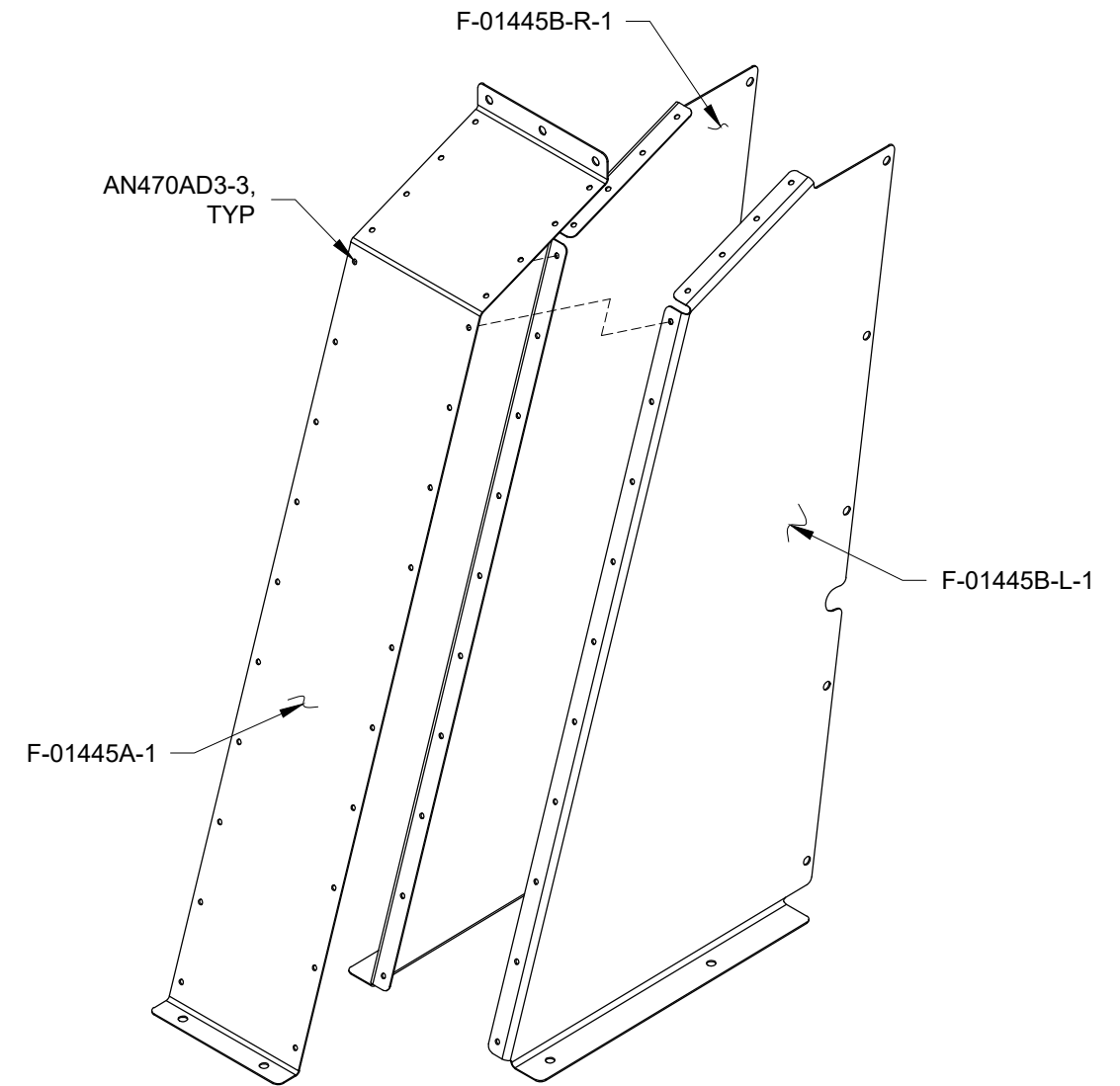
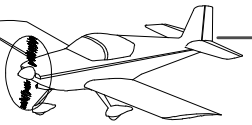

FIGURE 2: FLAP MOTOR COVER ASSEMBLY



Step 1: Install the Flap Motor Cover Assembly with the hardware called out in Figure 1.

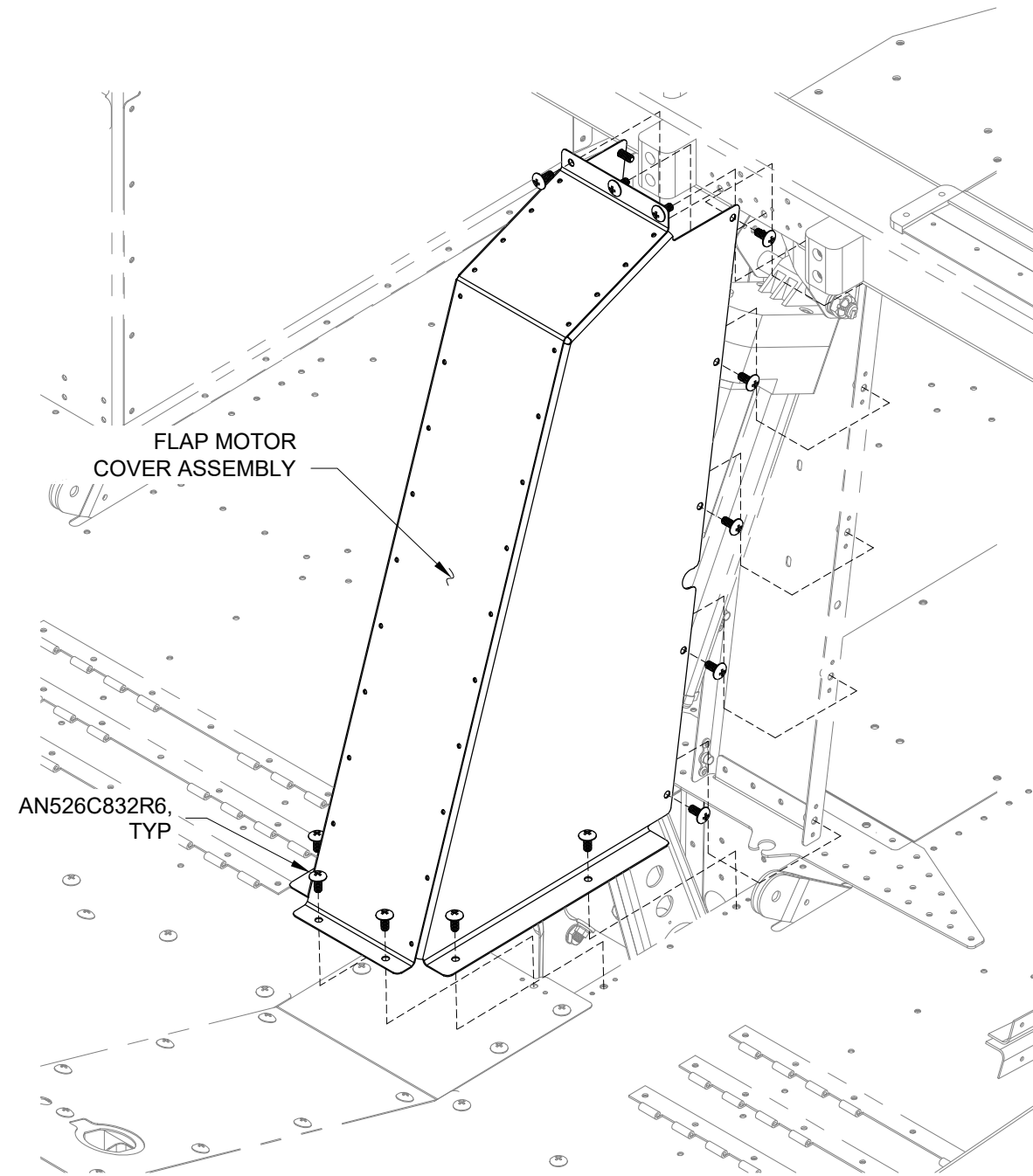
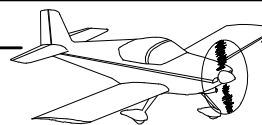

FIGURE 1: FLAP MOTOR COVER INSTALLATION



THIS PAGE INTENTIONALLY LEFT BLANK