



## SERVICE LETTER 00022

**Date Released:** November 20, 2020

**Date Effective:** November 20, 2020

**Subject:** Short WD-01214-L/R-1 Flaperon Torque Tubes

**Affected Models:** ELSA RV-12iS Finish Kits shipped between March, 2018 and October 12, 2020

SLSA RV-12iS aircraft:  
Serial Numbers 120075 to 120094

**Required Action:** Affected aircraft should install spacer washer

**Time of Compliance:** Within the next 10 flight hours

**Supersedes Notice:** Not Applicable

**Labor Required / SLSA Warranty Allowance:** 0.75 Hours

**Level of Certification:** SLSA: LSA Repairman Maintenance or A&P  
ELSA: Owner (certification not required)  
*Check the rules of the local controlling authority/agency and the operating limitations for your aircraft.*

### Synopsis:

Builder feedback indicated several WD-01214-L/R-1 Flaperon Torque Tubes were fabricated using tubes with insufficient length which resulted in reduced engagement between the torque tube and the A-1211 Pivot Guide. Complying with this service letter adds a spacer to reestablish correct torque tube to pivot guide engagement.

### Materials Required:

The following materials are required to complete the steps necessary to achieve compliance with this notification.

Purchase Part SL-00022 from Van's Aircraft, which includes:

2 ea. AN3-13A  
2 ea. MS21042-3  
6 ea. NAS1149F0363P  
2 ea. WASHER-00022

**Method of Compliance:**

Step 1: Compare WD-01214-L-1 and WD-01214-R-1 torque tubes to the dimension shown in Figure 1. If the measurement is 0.75 in. [19 mm] instead of the 0.875 in. [22 mm] dimension shown, WASHER-00022 should be installed.

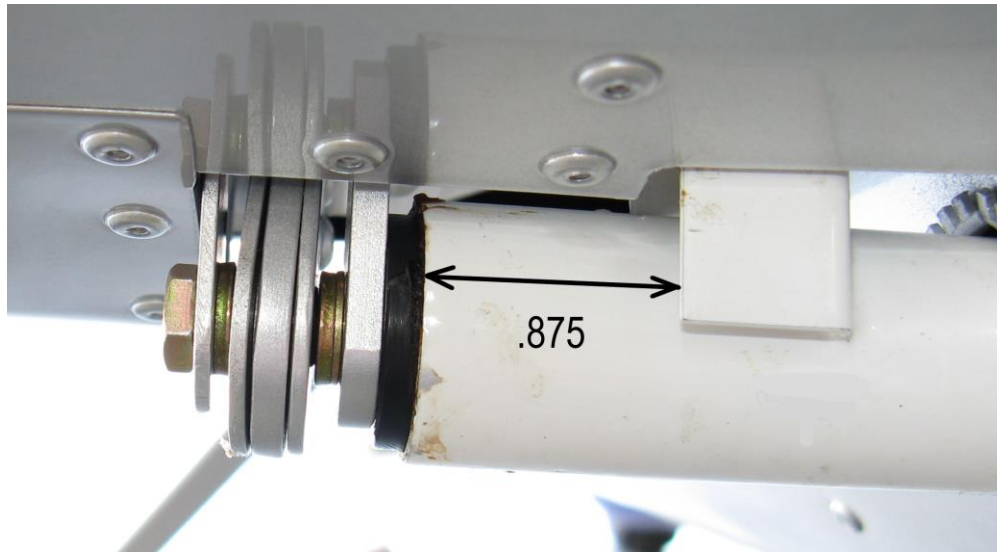
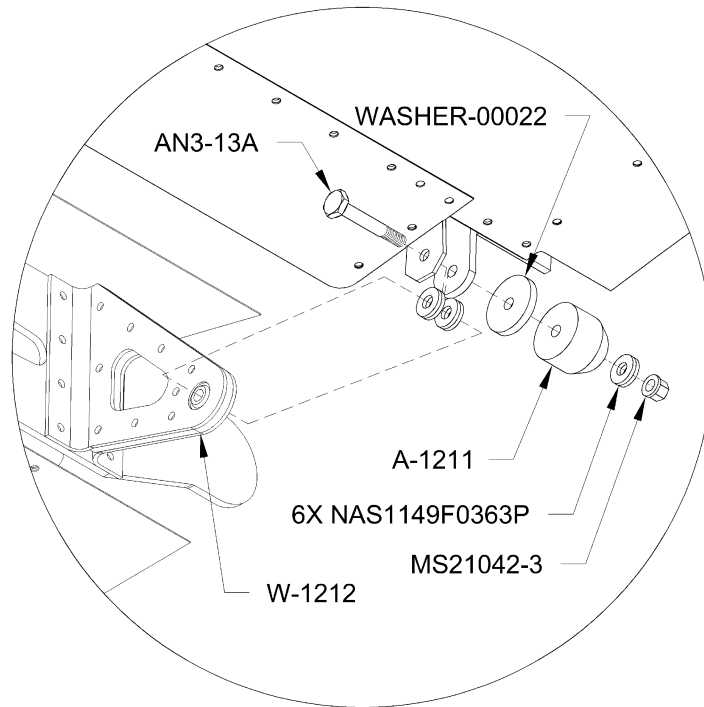

**FIGURE 1: WD-01214-L/R-1 SHOULD MEASURE .875 IN.**

Step 2: To install WASHER-00022, remove the wing just enough to allow access to the nut attaching the A-1211 Pivot Guide. See the Maintenance Manual for the wing removal procedure.

Step 3: Remove the bolt attaching the flaperon to the W-1212 Inboard Flaperon Hinge and discard the bolt and nut. The washers may be reused. See KAI Section 38iS/U.

Step 4: Install the AN3-13A bolt, washers, WASHER-00022, A-01211 Pivot Guide, and remaining hardware shown in Figure 2. Torque the MS21042-3 nut to 25 in-lbs.



**FIGURE 2: INSTALL WASHER-00022**

Step 5: Reinstall the wing.

Step 6: Repeat Steps 2-5 for the other wing if required.

Step 7: Cycle the controls to check for and ensure smooth operation.

Make a logbook entry indicating compliance with service document per the requirements of the controlling authority/agency.

Place a copy of this notification in the back of the maintenance manual for your aircraft. Note the addition of this notification to the bottom of the Maintenance Manual table of contents.

If you are no longer in possession of this aircraft, please forward this information to the present owner/operator and immediately notify Van's Aircraft, Inc. via email at [registrations@vansaircraft.com](mailto:registrations@vansaircraft.com).

Information regarding establishing/transferring aircraft ownership, registration and licensing is available at: <https://www.vansaircraft.com/qr/transfer-of-ownership/>