

**REVISION DESCRIPTION:**

**50-05 REV 4:** "Step 1: Remove and discard the throttle return spring supplied with the engine"

was "Step 1: Remove the throttle arm by removing the nut and spring washer called out in Figure 1. Remove and discard the throttle return spring supplied with the engine."

"Step 2: Connect the SPRING-00002 Throttle Return Spring supplied with the throttle cable to the throttle arm then to the cable support as shown in Detail A. Use a needle nose pliers wrapped in tape to avoid damaging the spring."

was "Step 2: Connect the SPRING-00002 Throttle Return Spring supplied with the throttle cable to the throttle arm then to the cable support. Note the orientation of the spring as shown in Detail A

Re-install the throttle arm, spring washer and nut to the carburetor assembly. Torque the nut to the value specified by the Rotax Illustrated Parts Catalog."

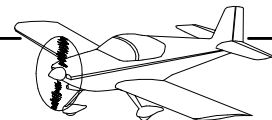
In Figure 1, "SPRING-00002" was "SPRING-06748 (MCFARLANE PART 6748)"

Added Detail A showing orientation of SPRING-00002 installation.

Removed Step 5.

Removed Figure 2.

**50-06 REV 3:** In Figure 2, "SPRING-00002" was "SPRING-06748 (MCFARLANE PART 6748)"



**NOTE:** Instruction for synchronizing the carburetors is found in the RV-12 Maintenance Manual. Complete all sections of the RV-12 Assembly Instructions prior to synchronizing the carburetors.

The remaining steps in this section provide cable installation for the right carburetor. Cable installation on the left carburetor is a mirror of the right and should be done at the same time.

**CAUTION:** Installing the SPRING-00002 Throttle Return Spring without removing the throttle arm may distort the spring.

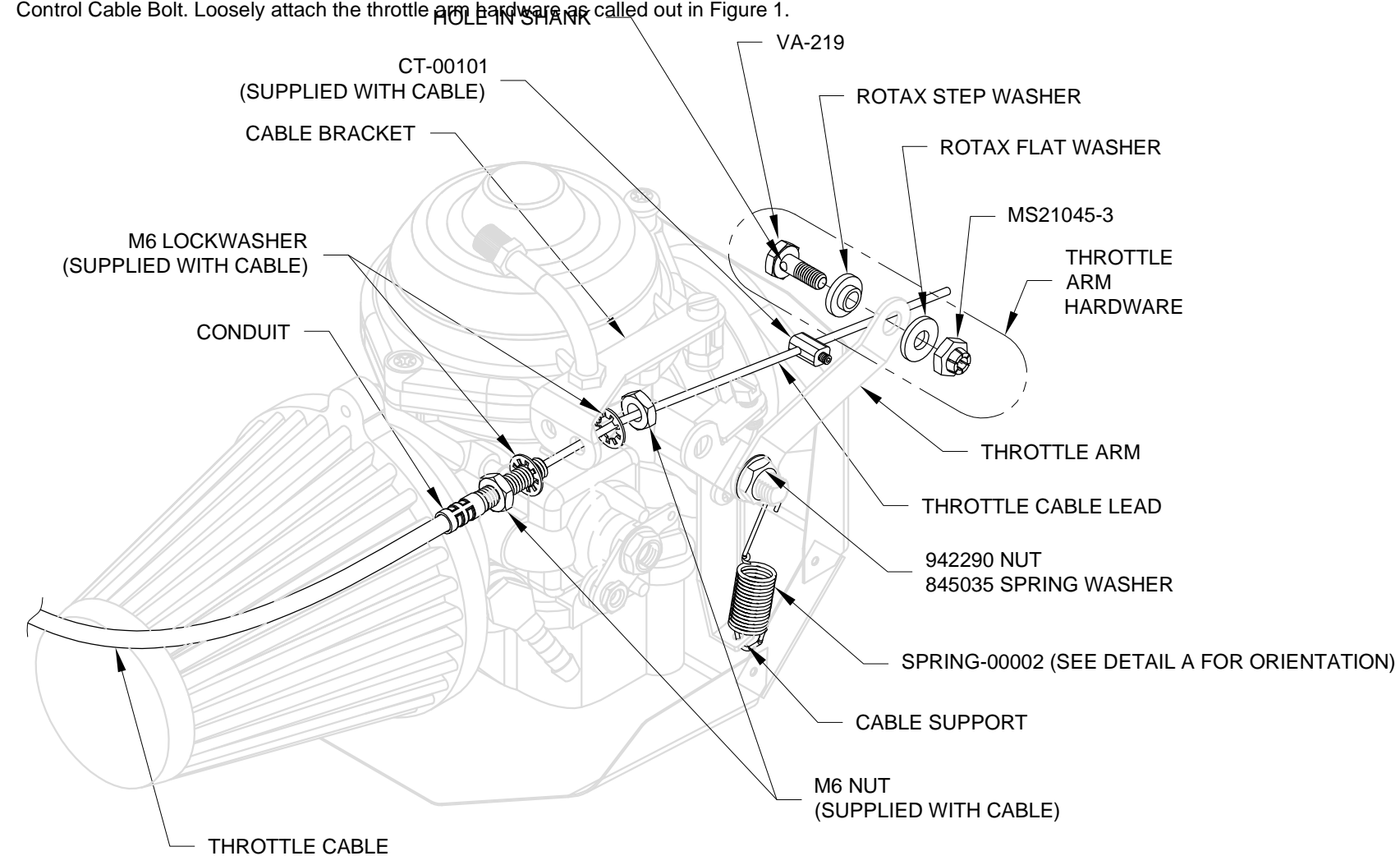
**Step 1:** Remove the throttle arm by removing the nut and spring washer called out in Figure 1. Remove and discard the throttle return spring supplied with the engine.

**Step 2:** Connect the SPRING-00002 Throttle Return Spring supplied with the Throttle Cable to the throttle arm then to the cable support. Note the orientation of the spring as shown in Figure 1.

Re-install the throttle arm, spring washer and nut to the carburetor assembly. Torque the nut to the value specified by the Rotax Illustrated Parts Catalog.

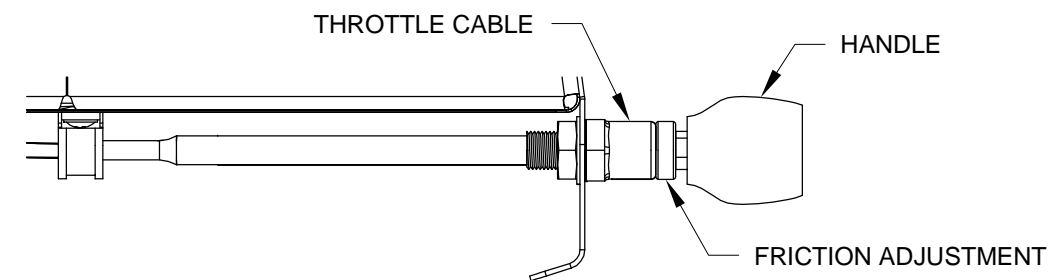
**Step 3:** Install the conduit of the right Throttle Cable (the longer of the two cables) to the cable bracket using the hardware called out in Figure 1. Adjust the nuts so that the cable bracket will be approximately centered on the threaded portion of the conduit, then tighten.

**Step 4:** Thread the Throttle Cable lead through the CT-00101 Stop Nut and into the hole in the shank of the VA-219 RV-12 Control Cable Bolt. Loosely attach the throttle arm hardware as called out in Figure 1.

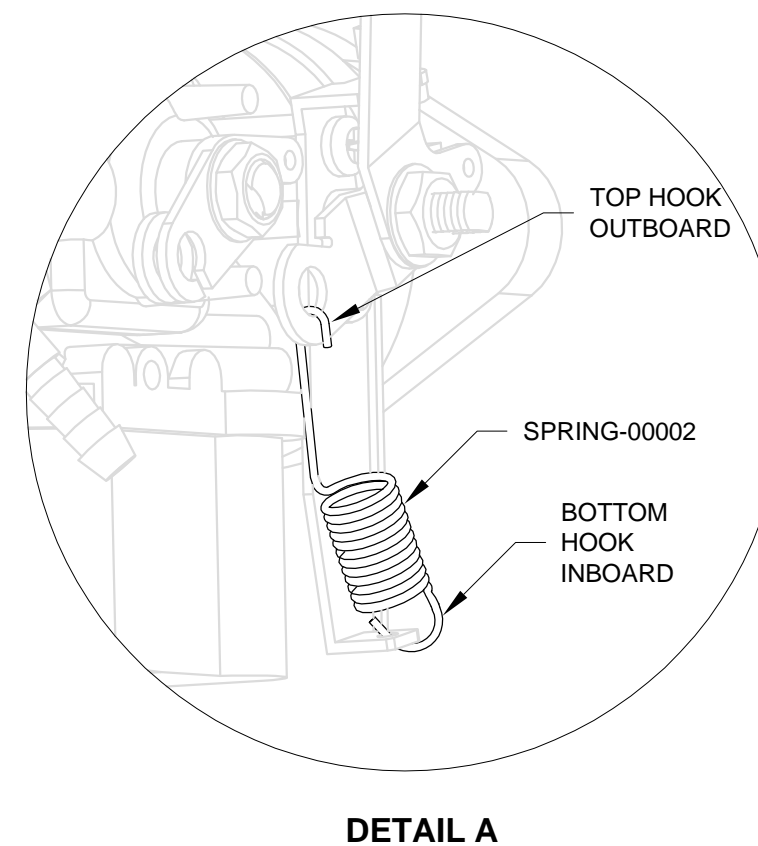


**FIGURE 1:**  
THROTTLE CABLE TO CARB CONNECTION

**Step 5:** Push the Throttle Cable handle all the way in to the friction adjustment as shown in Figure 2. Temporarily tighten the friction adjustment.



**FIGURE 2:** THROTTLE HANDLE POSITION



**DETAIL A**



Step 1: Pull the throttle handle away from the instrument panel the distance prescribed in Figure 1, then tighten the friction adjustment. This is the idle position.

Step 2: Actuate the throttle arm so that the idle stop is lightly contacting the idle speed adjustment screw. While holding tension on the throttle cable lead, tighten the throttle cable locking hardware to 8-10 in-pounds. See Figure 2. Insure that the idle speed adjustment screw is resting on the idle stop and that there is no clearance between the two when the throttle handle is in the idle position.

Move the CT-00101 Stop Nut against the end of the cable housing and tighten the set screw. The final position will be adjusted during the carburetor balance procedure.

Step 3: Loosen the friction adjustment.

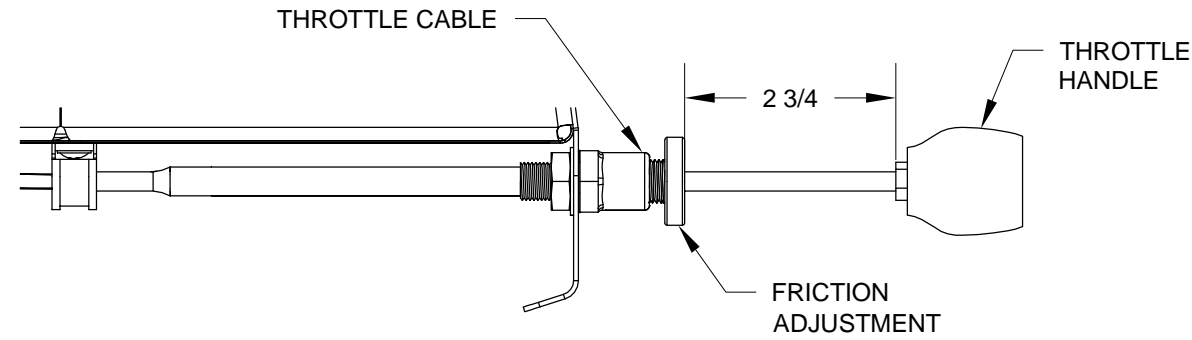


FIGURE 1: THROTTLE HANDLE POSITION

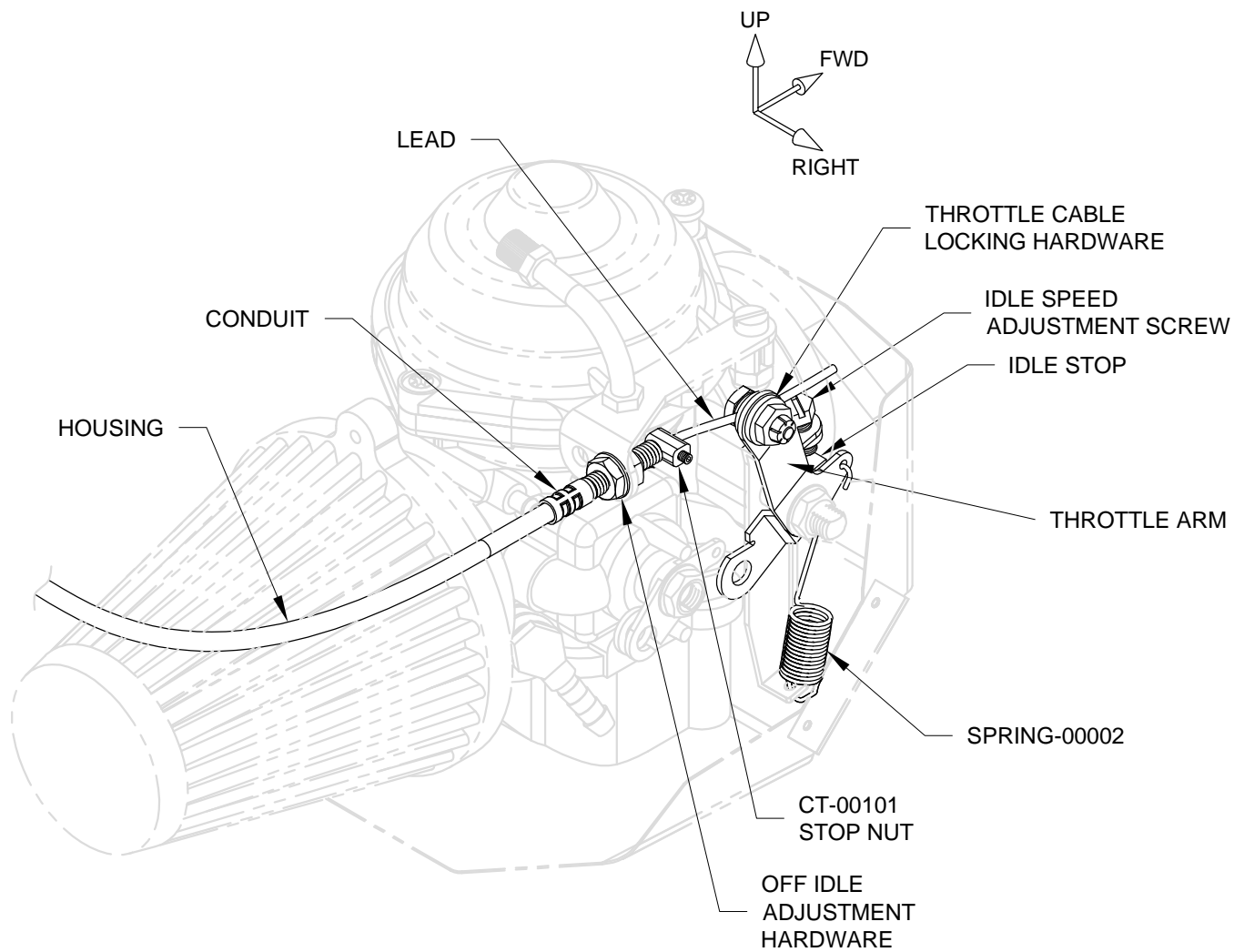


FIGURE 2: THROTTLE CABLE TO CARB CONNECTION

Step 4: Trim the Throttle Cable lead to the dimension given in Figure 3.

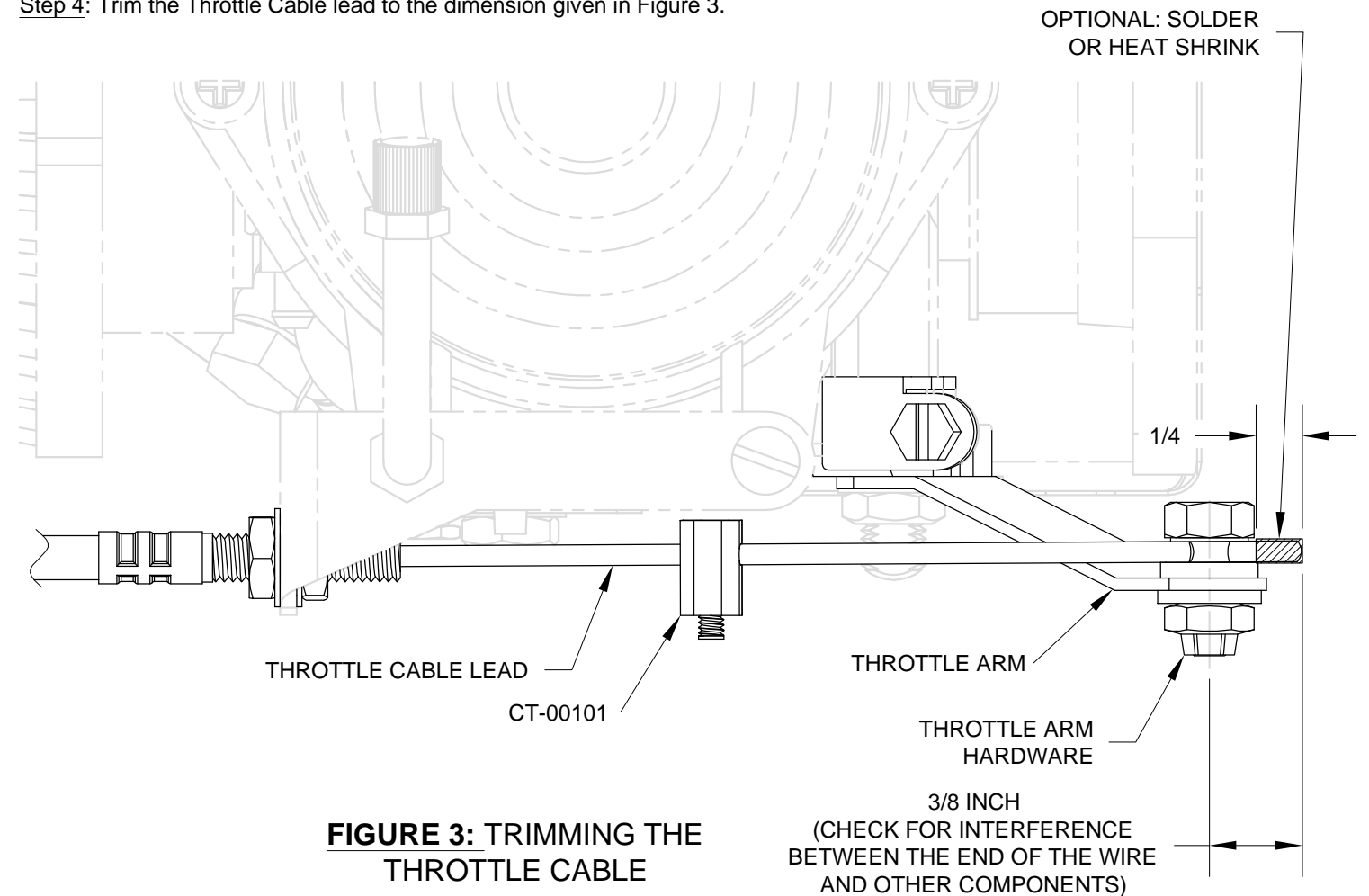


FIGURE 3: TRIMMING THE THROTTLE CABLE