

**Step 1:** Separate from the WH-RV12-ROTAX Firewall Forward Wiring Harness the WH-Q143 (BRN) and WH-Q144 (BRN) Fuel Pressure Wires.

**Step 2:** Strip the ends of the WH-Q143 (BRN) and WH-Q144 (BRN) Fuel Pressure Wires then attach a female spade connector to each wire per the callouts in Figure 1.

**Step 3:** Attach the WH-Q143 (BRN) and WH-Q144 (BRN) Fuel Pressure Wires to the spade connectors coming from the studs on the 100411-000 Fuel Pressure Sensor as shown in Figure 1. It does not matter which wire goes to which stud.

**Step 4:** Route the WH-RV12-EGT Exhaust Gas Temp Wiring Harness, the WH-RV12-POWER Power Wiring Harness and the remaining WH-RV12-ROTAX Fwall Fwd Wiring Harness through the cushioned clamp attached to the WD-1221 Engine Mount Standoff.

**Step 5:** The WH-RV12-POWER Power Wiring Harness consists of two wires coming from a plastic clip attached to the back of the AV CONTROL BOARD 12. Separate out the WH-P156 (WHT) wire that splits into two wires three inches from the end. See Figure 2.

**Step 6:** Insert each of the spade connectors on the ends of the WH-P156 (WHT) wires into the 965 335 Connector Housing (supplied with the engine) locations shown in Figure 2. Check that the connectors are locked in place by gently tugging on each wire.

**Step 7:** Separate from the WH-RV12-ROTAX Firewall Forward Wiring Harness the WH-P45 (YEL) Voltage Regulator Control Wire.

**Step 8:** Insert the spade connector on the end of the WH-P45 (YEL) Voltage Control Wire into the 965 335 Connector Housing location shown in Figure 2. Check that the connector is locked in place by gently tugging on the wire.

**Step 9:** Insert the 965 335 Connector Housing into the 965 347 Rectifier Regulator as shown in Figure 1.

**Step 10:** Strip, then crimp the end of the WH-B148 Power Outlet +V wire (routed in the fuselage kit) in the open end of the butt splice attached to the ES ZC-210B In-Line Fuse Holder. See Figure 1.

**Step 11:** Separate out and strip the ends of both red and both yellow wires coming from the brown WH-RV12-EGT Exhaust Gas Temp Wiring Harness and crimp on ES 421-0107 spade connectors to the end of each wire.

**Step 12:** Find both 100405-001 EGT Sensors.

Snip off the existing spade terminals leaving as much wire as possible.

Strip the end of the wires then crimp on ES 421-0108 spade connectors to the end of each wire.

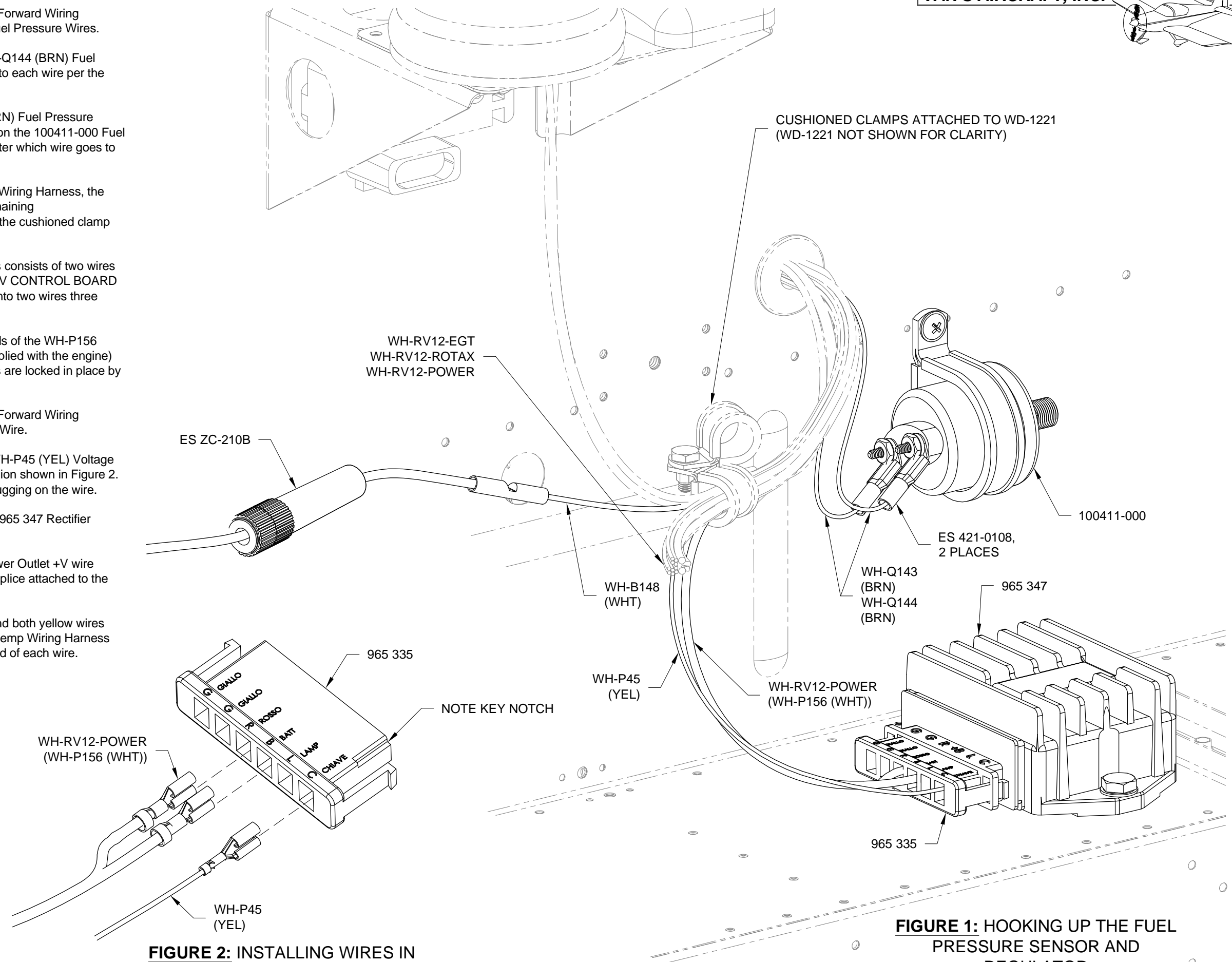

**FIGURE 2: INSTALLING WIRES IN THE CONNECTOR HOUSING**

**FIGURE 1: HOOKING UP THE FUEL PRESSURE SENSOR AND REGULATOR**