

Step 1: Reattach the Cowl 12 Oil Door Assembly to the oil door hinge lugs using the hardware called out in Figure 1. Tighten the nuts until the play is gone and the door will stay open on its own. Close the oil door and secure the camlocks.

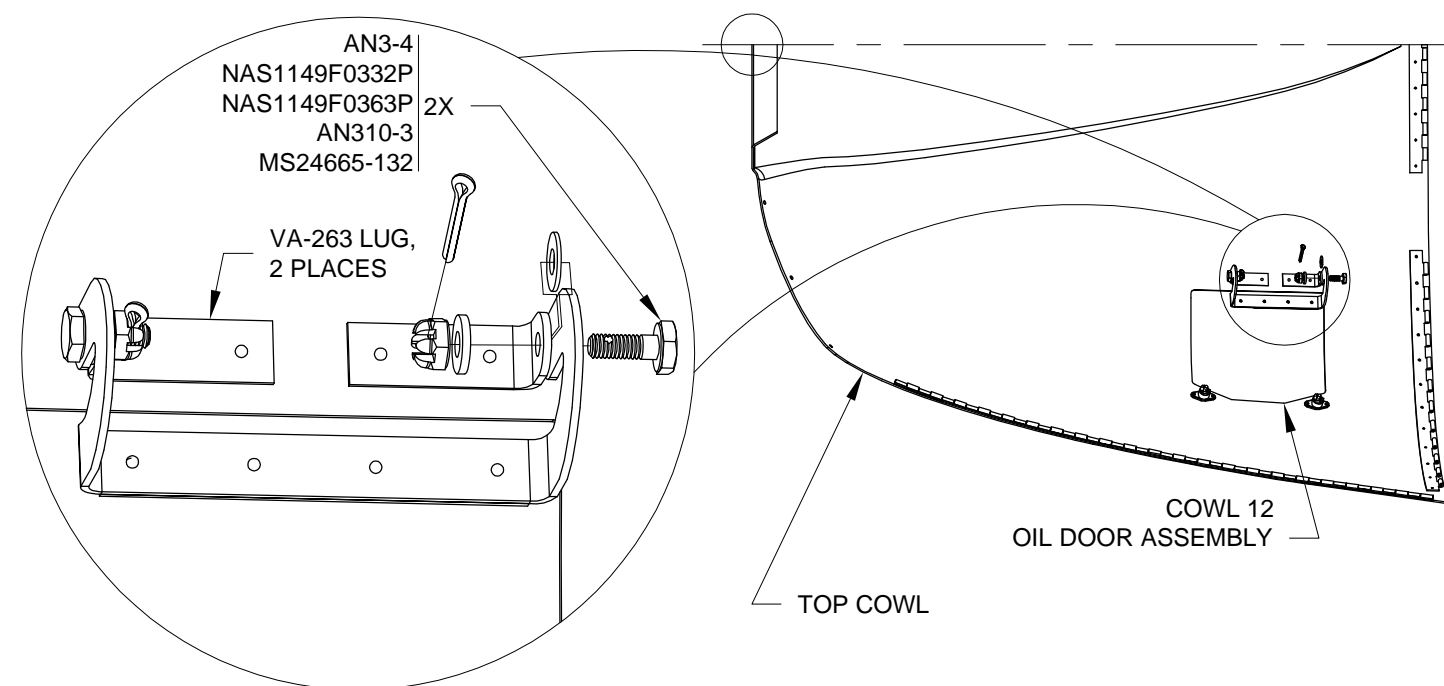

FIGURE 1: OIL DOOR ASSEMBLY INSTALLATION

Step 2: Remove the middle nose gear attach bolt indicated in Figure 2.

Step 3: Slip the middle nose gear attach bolt through the F-1285B-1 Cowl Close-out Bracket so that the bracket is perpendicular to the bottom of the aircraft with the angled flange sweeping up towards the front. See Figure 2.

Step 4: Bend the F-1285 Cowl Bottom Close-out to fit the curve of the bottom cowl. Slip the cowl bottom close-out around the WD-1201 Nose Gear Assembly and inside the bottom cowl.

Attach the cowl bottom close-out to the F-1285B-1 Cowl Close-out Bracket using the hardware called out in Figure 2. Align the edges of the cowl bottom close-out with the edges of the slot in the bottom of the bottom cowl. Clamp the cowl bottom close-out to the bottom cowl.

Step 5: Match-Drill #19 the nutplate screw holes into the cowl bottom. Insert a screw in the top of each hole to maintain alignment while drilling.

Step 6: Remove the F-1285 Cowl Bottom Close-out. Dimple the nutplate rivet holes in the cowl bottom close-out and the rivet holes in the corresponding nutplates. See Figure 2. Rivet the nutplates to the cowl bottom close-out as shown in Figure 2.

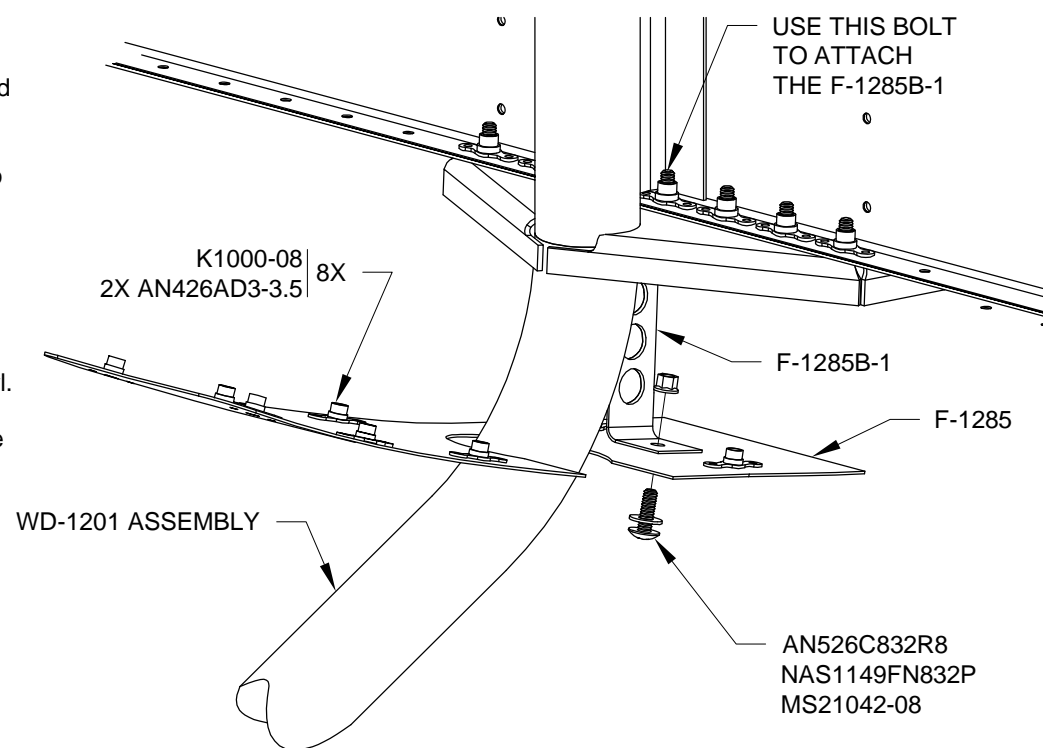

FIGURE 2: CLOSEOUT BRACKET ATTACH

Step 7: Install the F-1285 Cowl Bottom Close-out and attach the bottom cowl to the close-out using the hardware called out in Figure 3. Use a sanding block to remove the excess fiberglass if the aft edge of the cowl extends beyond the aft edge of the F-1285 Cowl Bottom Close-out.

Step 8: Drill #30 a pilot hole through each of the nutplates on the F-12118 Cowl Attach Plates into the bottom cowl. Remove the cowl and final-drill #19 the four pilot holes. See Figure 3.

Step 9: Install the bottom cowl and attach the hardware called out in Figure 3. Install the top cowl and secure with the hinge pins.

Step 10: When installed there should be a minimum 1/32 gap on all cowl edges and between the cowl and fuselage to allow for paint. Use a sanding block to remove additional material from the top cowl and bottom cowl as required.

NOTE: Do not sand or finish the outside surface of the cowl at this time, translucency will be required for duct installation.

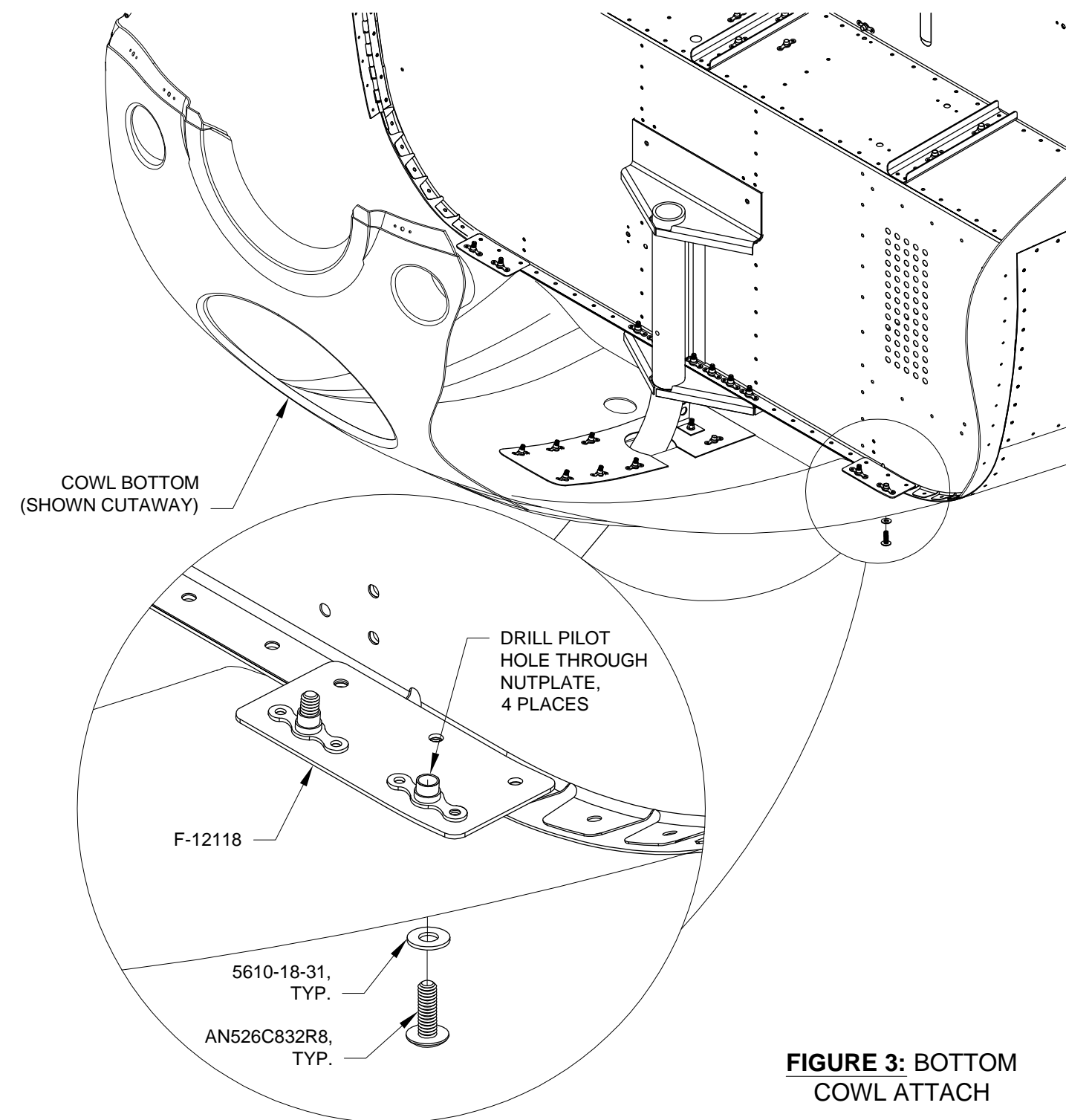

FIGURE 3: BOTTOM COWL ATTACH