

Step 1: Using a 3/8" bit, final-drill the two 3/16" holes in the top of the Firewall Assembly common to the WD-1221 Engine Mount Standoff. Be sure to drill perpendicular to the vertical face of the Firewall Assembly. Deburr the holes in the Firewall Assembly.

Step 2: Permanently bolt the WD-1221 Engine Mount Standoff to the Firewall Assembly using the hardware called out in Figure 1. If the bolt holes do not align, up to 1/32 may be filed from edges of holes to allow bolts to pass through the Firewall Assembly and into the engine mount standoff.

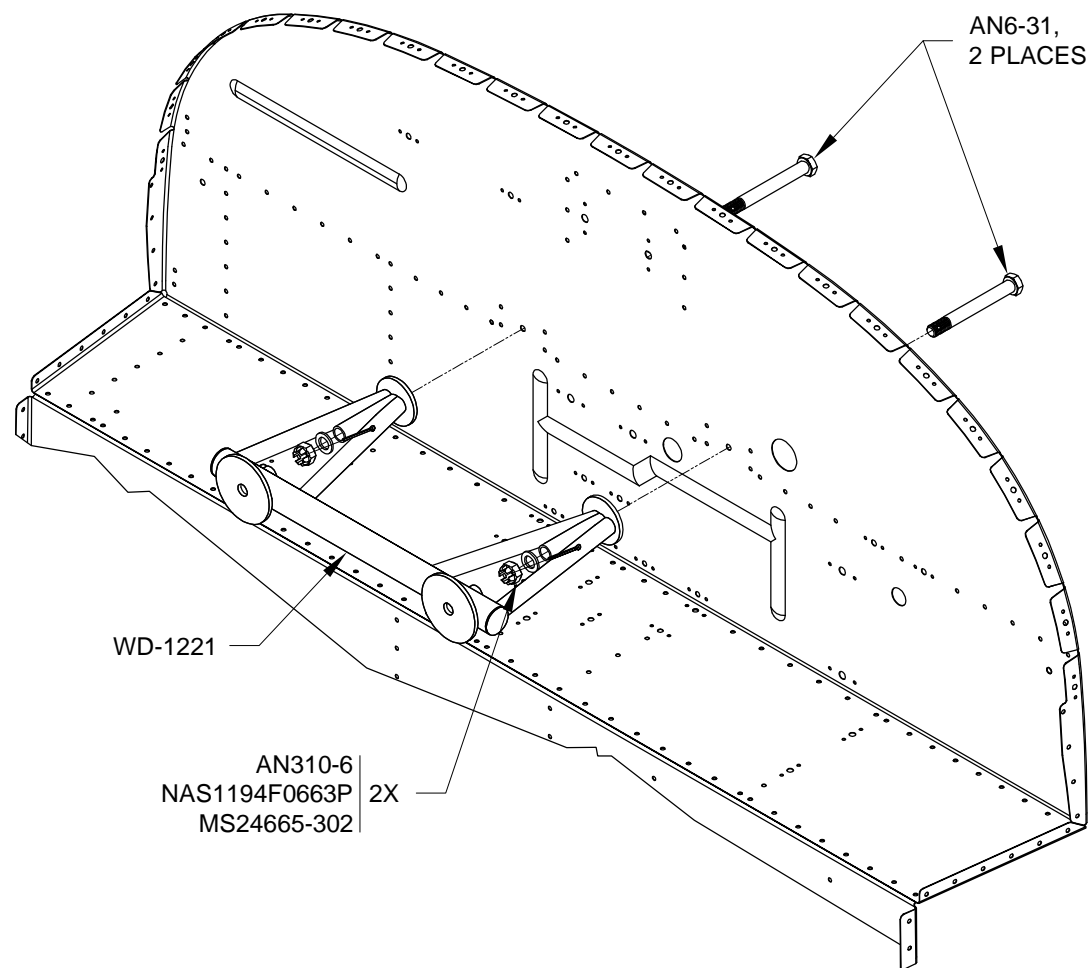

FIGURE 1: ATTACHING THE ENGINE MOUNT STANDOFF

NOTE: See the documentation included with the wheel and brake package for helpful assembly tips, recommended torque, lubricants, fluids and sealant.

Step 3: Split the U-WHLNW51CC.G25 Nose Wheel Assembly by removing the bolts holding the two Wheel Halves together.

Step 4: Remove the nut and washers from the valve stem of the U 5:00X5-6IT Tube (not shown in Figure 2). Dust the tube and the inside of the U 5:00X5-6 Tire with talcum powder. The notch on the wheel half should be aligned with the notch for the valve stem in the opposite wheel half. The red dot on the tire is installed next to the valve stem. Bolt the wheel halves together, taking care that the tube is not pinched between the wheel halves.

Step 5: SLOWLY inflate the tire. Deflate it fully and re-inflate it SLOWLY a couple more times to work out any wrinkles in the tube. Inspect for a good seat around the wheel rim. The final inflation pressure is 28 psi.

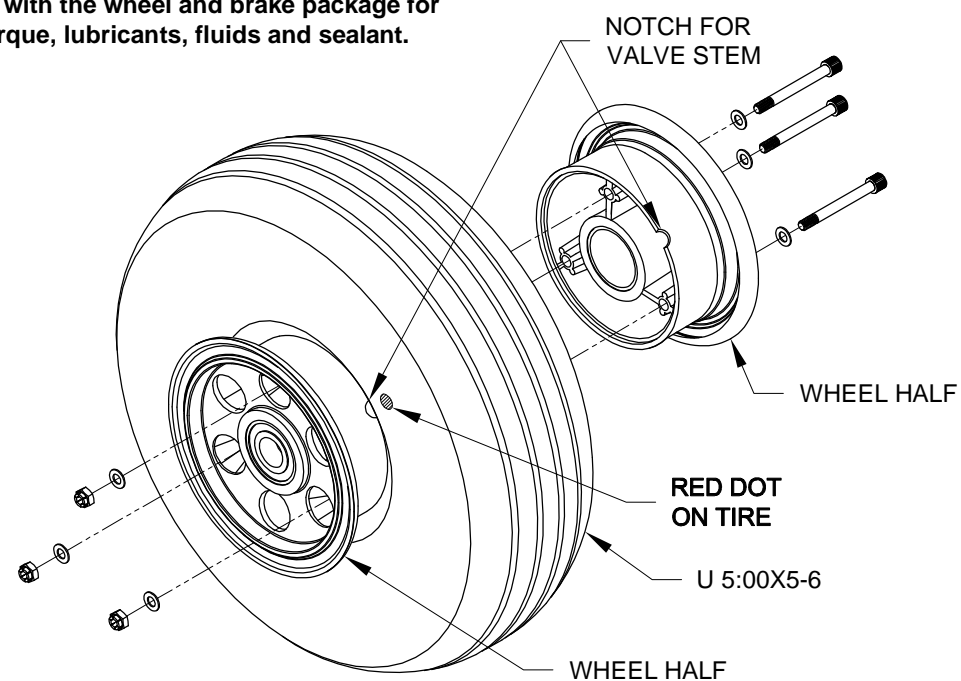

FIGURE 2: NOSE WHEEL AND TIRE ASSEMBLY

NOTE: Follow the instructions in Steps 6-9 for both Main Wheel and Tire Assemblies.

Step 6: Split the Main Wheel Assembly by removing the cap screws holding the Brake Disk to the wheel. Remove the bolts holding the Inner and Outer Wheel Halves together. Pull the bearings from the Main Wheel Assembly, clean and dry. Pay close attention to how the bearings, and hubs are installed so that they can be reinstalled in the same way. See Figure 3.

Step 7: Dust the U 5:00X5-6IT Tube (not shown in Figure 3) and the inside of the U 5:00X5-6 Tire with talcum powder, then mount the tube and tire on the Inner and Outer Wheel halves. The red dot on the tire is installed next to the valve stem of the tube (see Figure 3). Bolt the wheel halves together, taking care not to pinch the tube between the wheel halves. Carefully observe the manufacturer's bolt torque specifications shown on the document in the wheel/ brake package. Attach the brake disk with the cap screws and lockwire screws.

Step 8: SLOWLY inflate the tire. Deflate it fully and re-inflate it SLOWLY a couple more times to work out any wrinkles in the tube. It's a good idea to do this with the valve core removed; in the event a finger gets pinched the tire can be quickly deflated. The final inflation pressure is 28 psi.

Step 9: Be sure the bearings are fully greased and reinstall the bearings. See Figure 3.

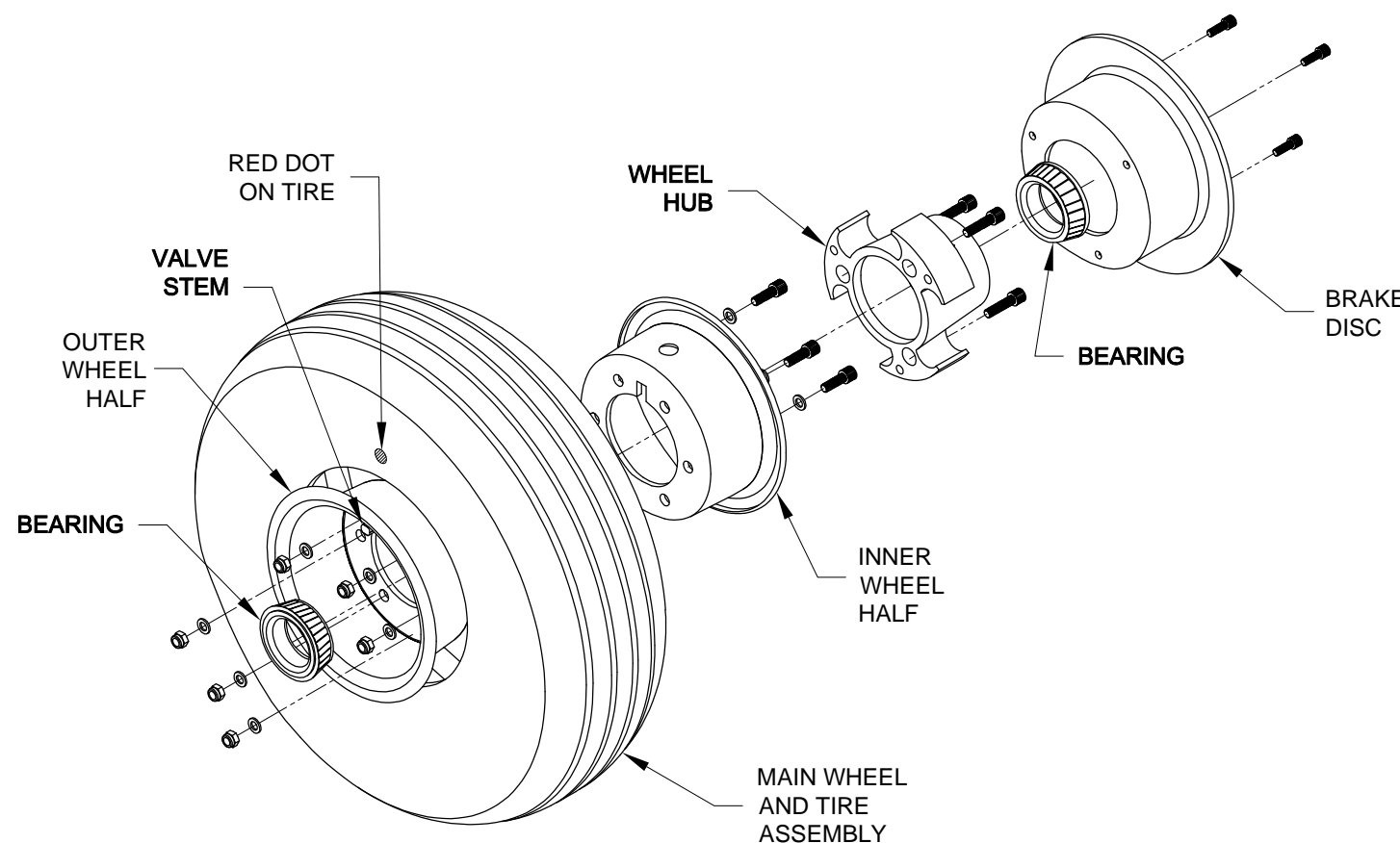

FIGURE 3: MAIN WHEEL AND TIRE ASSEMBLY