

**Step 1:** Purchase a set of  $\varnothing 7/8$  handle bar grips from a local bike shop. Remove the plug from the end and install the grips over the end of the WD-1212 Control Sticks. See Figure 1.

**Step 2:** Drill  $\varnothing 1/4$  a hole in the center of the handle bar grip plug. Remove the nut from the switch on each WH-RV12-PTT-P and WH-RV12-PTT-CP Push To Talk Harness and screw the switch into the plug from the bottom. Screw the nut back onto the switch.

**Step 3:** Starting at the top of the WD-1212 Control Sticks thread the WH-RV12-PTT-P and WH-RV12-PTT-CP Push To Talk Harnesses through and out the bottom of the control sticks. Loop the wires up and tie wrap them to the shank and the bottom of the gooseneck on the control sticks as shown in Figure 1.

**Step 4:** Temporarily install the WD-1212 Control Sticks as shown in Figure 2 by sliding a bushing into the stick and then using a bolt to attach the stick to the WD-1210 Control Column. See Page 32-05.

**Step 5:** Route the WH-RV12-PTT-P and WH-RV12-PTT-CP Push To Talk Harnesses through the snap bushing in the F-1215 Seat Ribs just inboard of the WD-1212 Control Sticks.

**Step 6:** Strip the end of each WH-F83 (BLK) PTT Ground Wire in the WH-RV12-PTT-P and WH-RV12-PTT-CP Push To Talk Harnesses. Crimp on a ring terminal as called out in Figure 1.

**Step 7:** On the left side of the aircraft use the hardware called out in Figure 1 to attach the ring terminal on WH-F83 (BLK) and the ring terminal on the WH-B183 (WHT) to the most inboard F-1215 Seat Rib (remove any primer or paint that would prevent the terminal from grounding).

**Step 8:** On the right side of the aircraft use the hardware called out in Figure 1 to attach the ring terminal on WH-F83 (BLK), WH-B183 (WHT) and WH-B54 (WHT) to the most inboard F-1215 Seat Rib (remove any primer or paint that would prevent the terminal from grounding).

**Step 9:** Route the remaining WH-F66 (WHT/BLU) PTT Transmit Wire from the WH-RV12-PTT-CP Co-Pilot Push To Talk Harness and WH-F67 (WHT/BRN) PTT Transmit Wire from the WH-RV12-PTT-P Pilot Push To Talk Harness forward through the snap bushing in the F-1203A and F-1202F Bulkheads, fuel flow cushioned clamp, up the back side of the firewall and over the rudder pedals, up through the F-1202B Panel Base, through the lower snap bushing in the F-1202K-L Inst Stack Support and through the cushioned clamp near the left ES CPU FAN. These wires will be added to the WH-RV12-TUNNEL harness later.

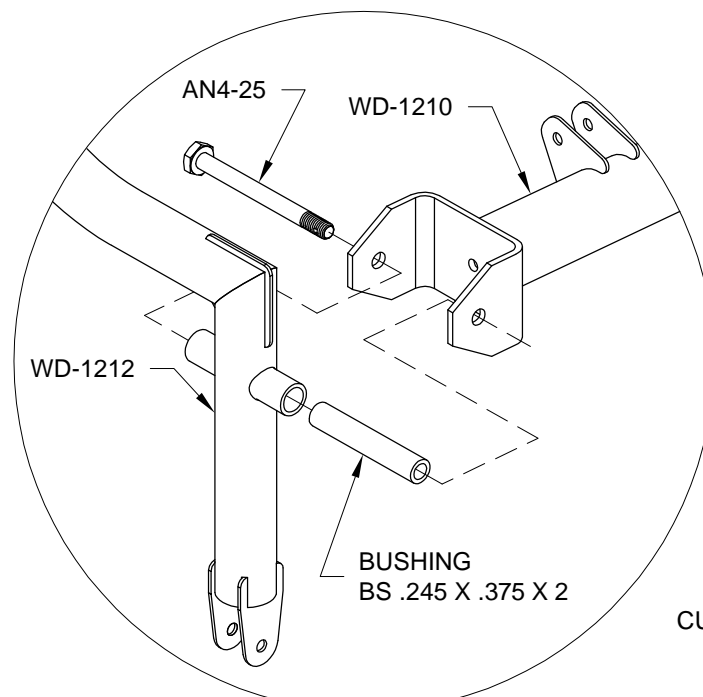
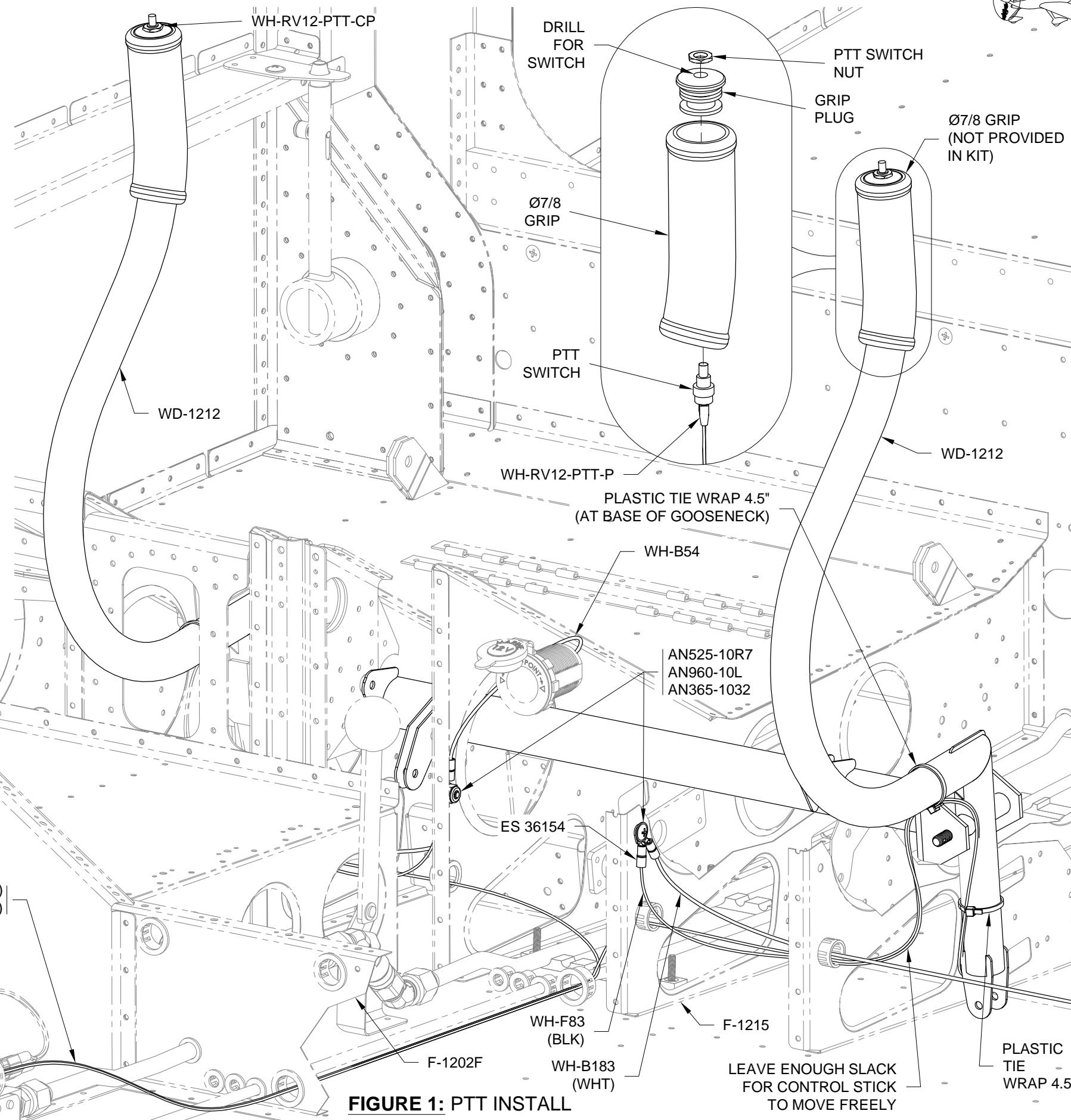

**FIGURE 2: ATTACHING THE CONTROL STICKS**

**FIGURE 1: PTT INSTALL**