

NOTE: The brake lines in this section are assembled with two different end fittings, the F 69-F-04x02 Brass Elbow and the F 179CA-4-2 Brass 45° Elbow. The only difference between the two assemblies is that the nut supplied with the brass 45° elbow has the sleeve attached to it. When directed to assemble the brake lines in this section, use the instructions of Steps 1-3 to attach the end fittings.

Step 1: Slide the nut and sleeve over the plastic tube, then locate the sleeve about 1/8 inch from the end as shown in Figure 1.

Step 2: Press the insert into the end of the plastic tube as far as possible by pushing it against some solid object.

Step 3: Place the end of the assembly in boiling water for about a minute, then immediately press the insert in the rest of the way until it bottoms against the end of the plastic tube.

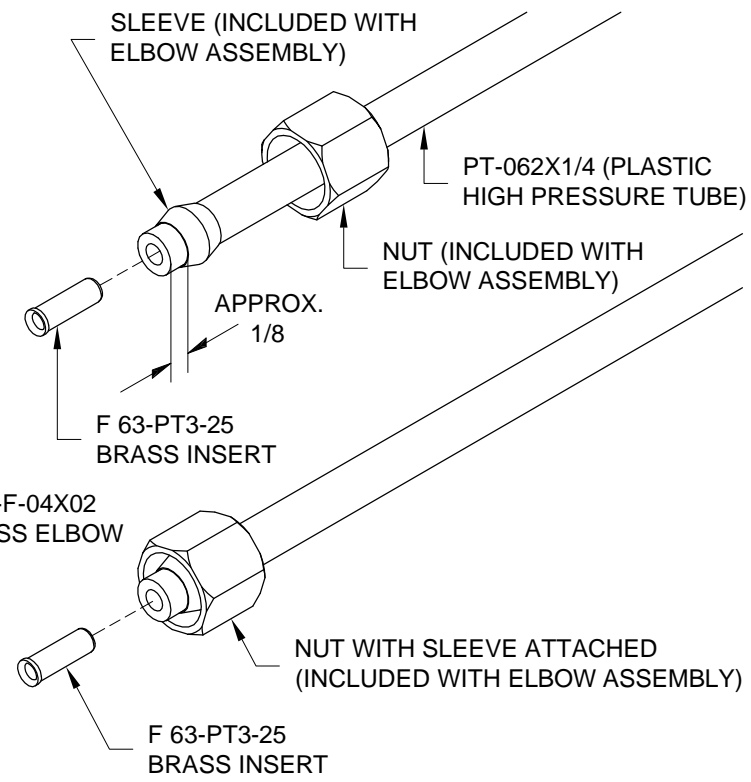

FIGURE 1: BRAKE LINE END FITTINGS

Step 4: Thread the brass elbows, called out in Figure 2, into the ports of the master cylinders as shown (use a small amount of pipe thread sealant on the threads). Note that the elbows in the lower ports are clocked to direct their corresponding brake lines between the elbows in the upper ports. The elbows in the upper ports are directed upward.

Step 5: Assemble the F-1289B-L & -R Cross-Over Brake Lines and connect them to their corresponding elbows as shown in Figure 2.

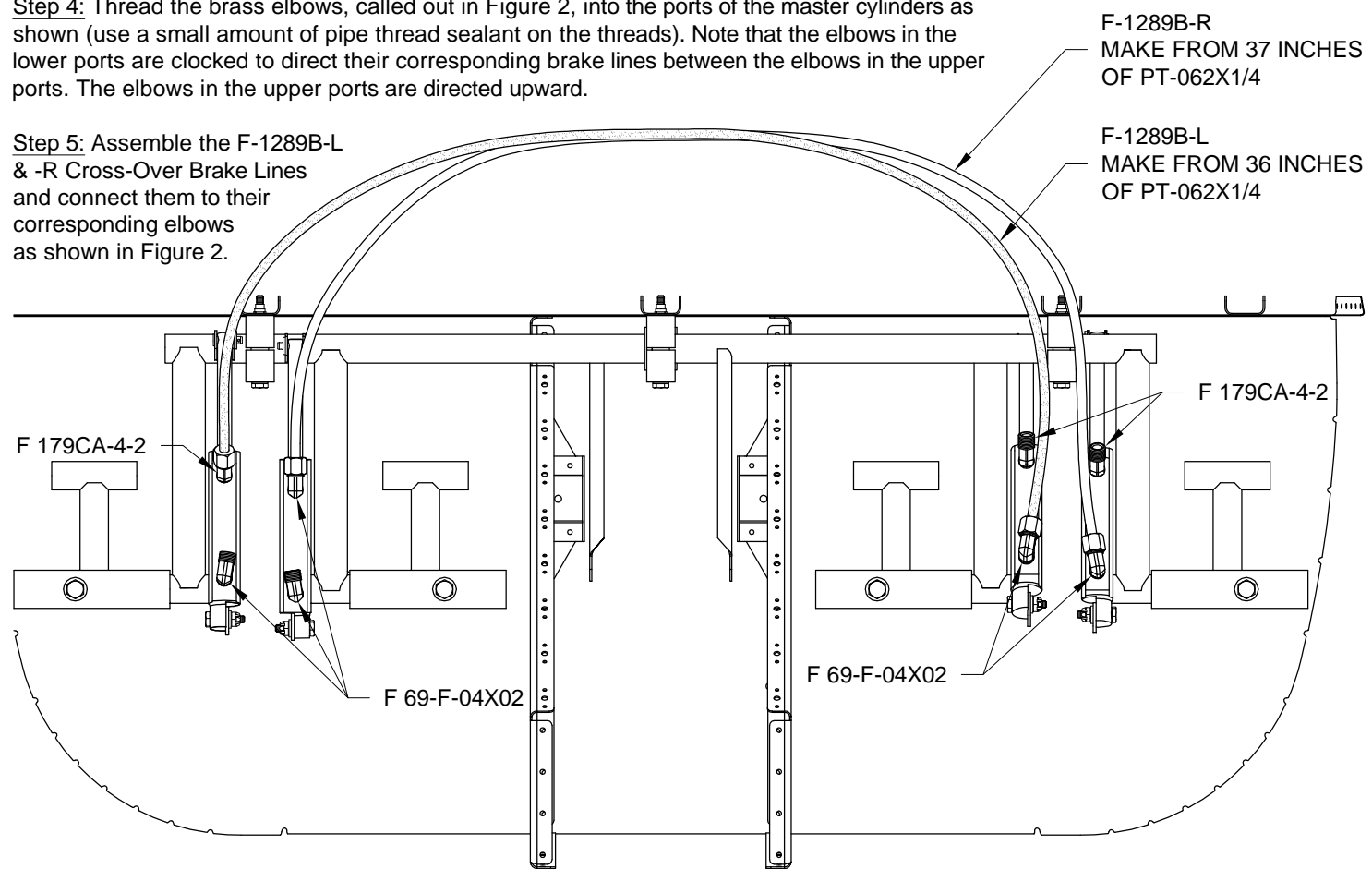

FIGURE 2: CROSS-OVER BRAKE LINES

Step 6: Final-Drill 5/16 both holes in three of the six F-1276C Systems Blocks, then place the three Systems Blocks over the studs in the F-1276 Bottom Skin as shown in Figure 3.

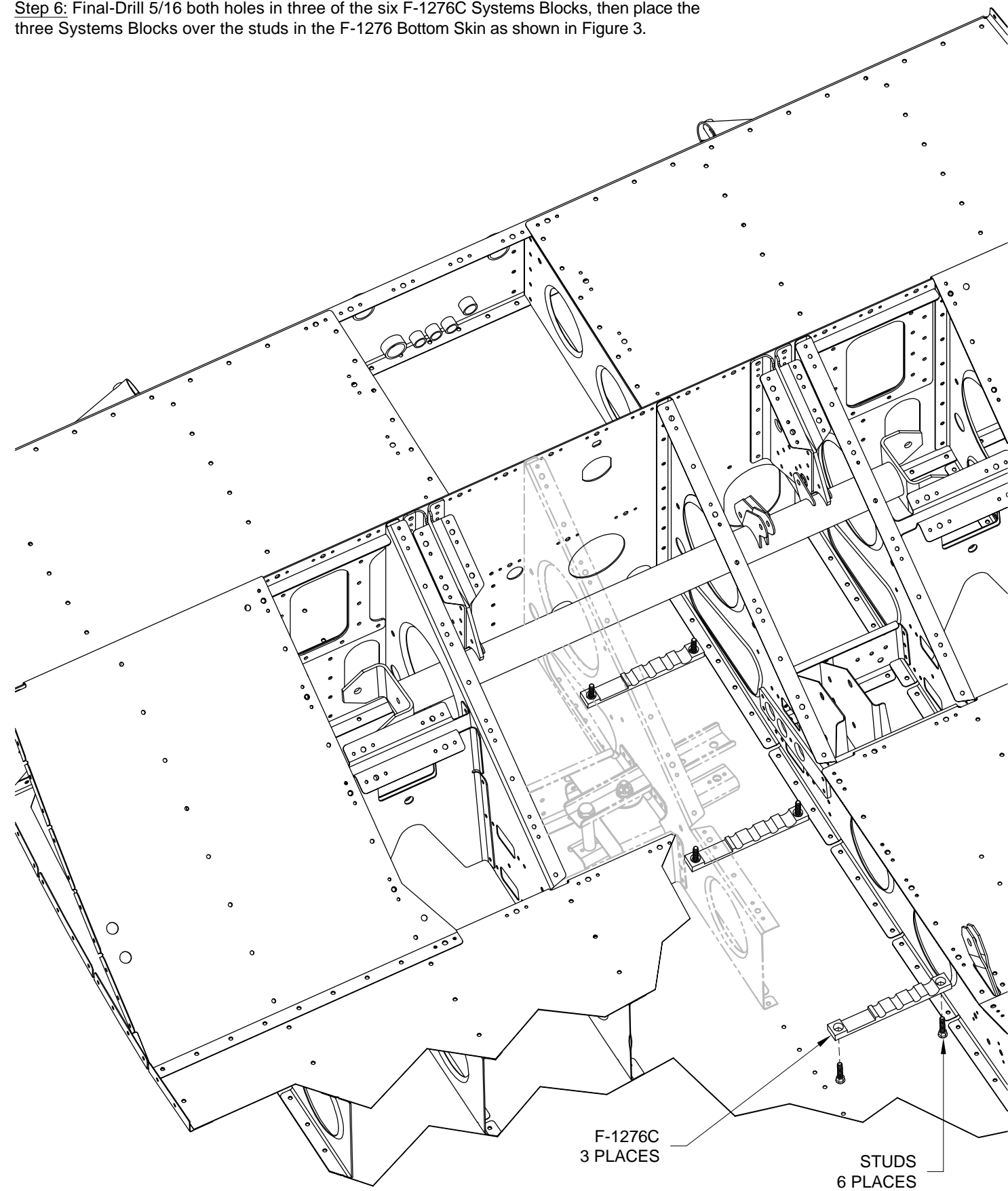

FIGURE 3: INSTALLING SYSTEMS BLOCKS