

Step 1: Cut two 12 foot lengths of string or fishing line (not supplied in kit).

Step 2: Starting from the most outboard W-1208 Nose Rib, route a length of string or fishing line inboard through the snap bushing in all of the nose ribs. Tape the ends of the string or fishing line on the most outboard and most inboard nose rib. Repeat process on the right wing. See Figure 1.

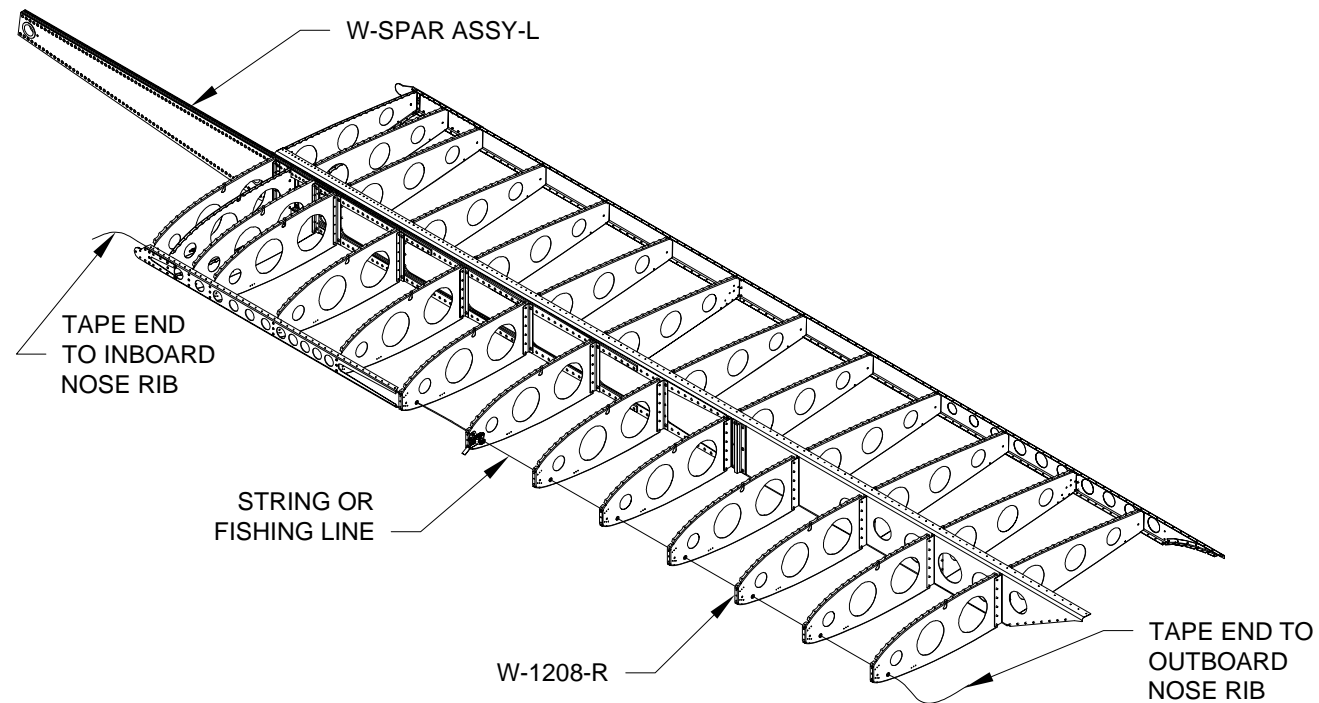

FIGURE 1: ROUTING LINE THROUGH RIBS

Step 3: Take the inboard end of the WH-B218 (WHT) Terminal Wire and attach a connector as shown in Figure 2. Ensure that the connector is properly installed.

Step 4: Make two WH-B216 (WHT) Terminal Ground Wires by cutting #18 wire to 5" lengths and attaching a connector to each end as shown in Figure 2.

Step 5: Attach the WH-B218 (WHT) Terminal Wire and one of the WH-B216 (WHT) Terminal Ground Wires to the W-1205-L Terminal Bracket as shown in Figure 2.

Step 6: Attach the second WH-B216 (WHT) Terminal Ground Wire to the W-1205-R Terminal Bracket as shown in Figure 2.

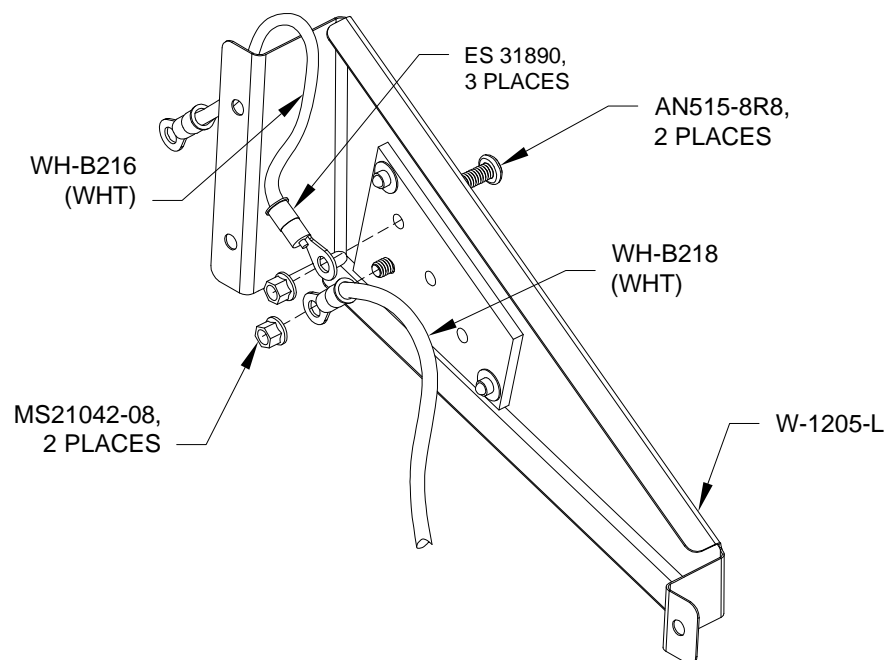

FIGURE 2: ATTACHING WIRES TO TERMINAL BRACKET

Step 7: Install the W-1205-L and W-1205-R Terminal Brackets as shown in Figure 3. Take care not to pinch wires between the attachment points. Route the WH-B216 (WHT) Terminal Ground Wires around the forward flange of the terminal brackets and fasten the connector with the terminal bracket mounting screw. Other wires should be neatly tucked behind terminal bracket.

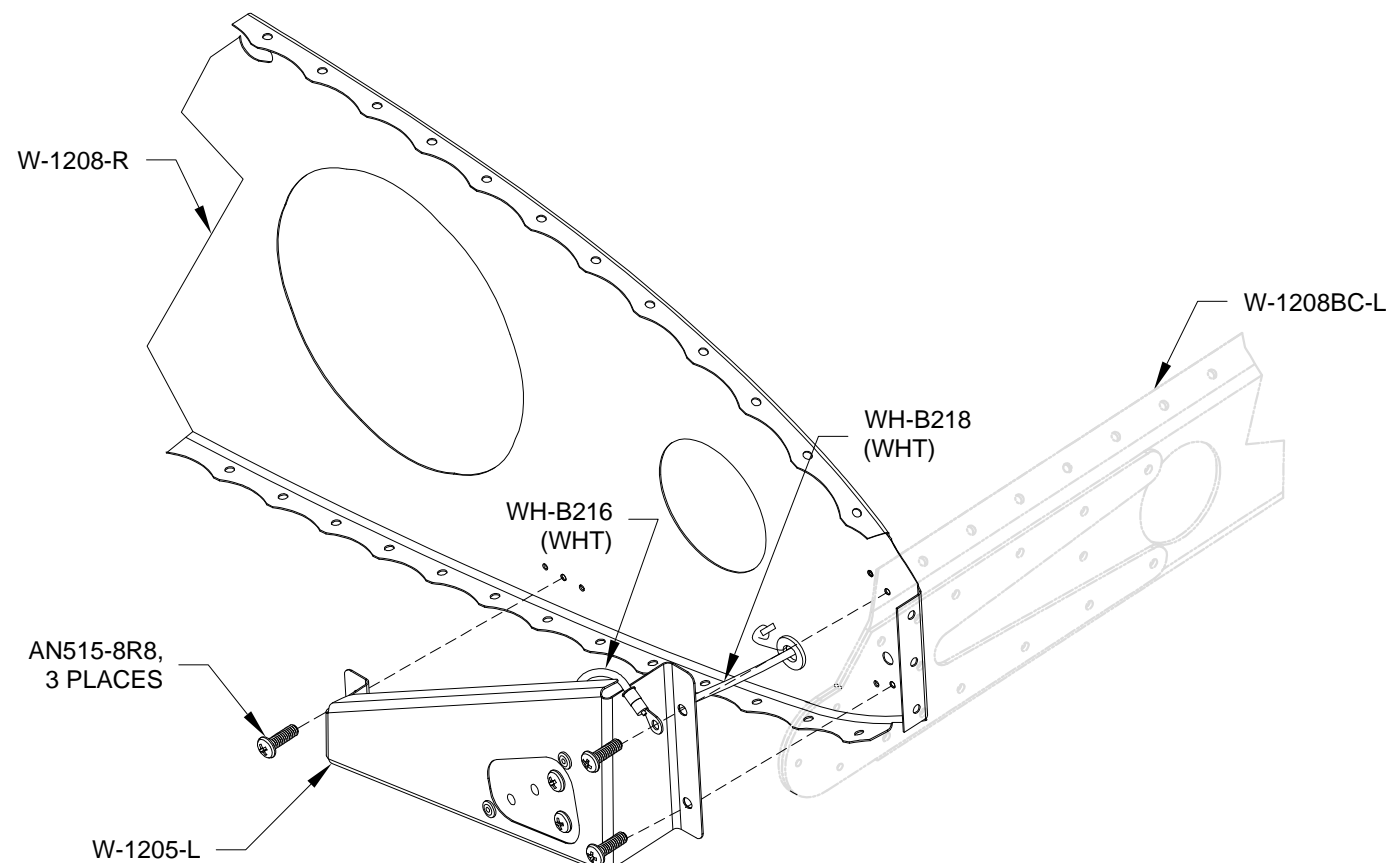

FIGURE 3: TERMINAL BRACKET INSTALLATION