

Step 1: Make four F-10104 Rudder Cable Links from 1/2 inch wide, .050 thick 4130 steel. The overall length will vary depending on the position that the rudder pedals were installed in. See Figure 1.

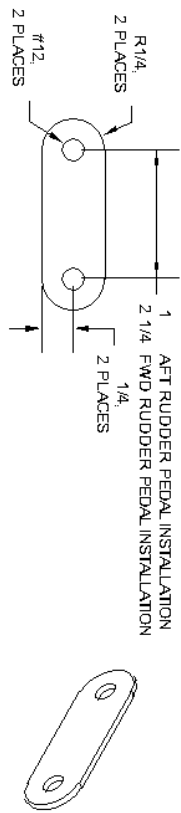

FIGURE 1: MAKING THE RUDDER CABLE LINKS

Step 2: Drill #27 a hole in one end of the F-1048G Rudder Cable Guide per the dimensions in Figure 2. Clamp the drilled guide to an un-drilled guide and match-drill #27 the hole into both parts. Mark a centerline on the non-slotted face of one of the guides. See Figure 3. Mark this pair of guides as a set then repeat this step for the remaining two guides.

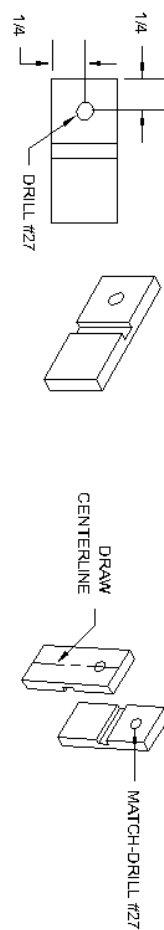

FIGURE 2: DRILLING THE GUIDE

FIGURE 3: MATCH-DRILLING THE GUIDE

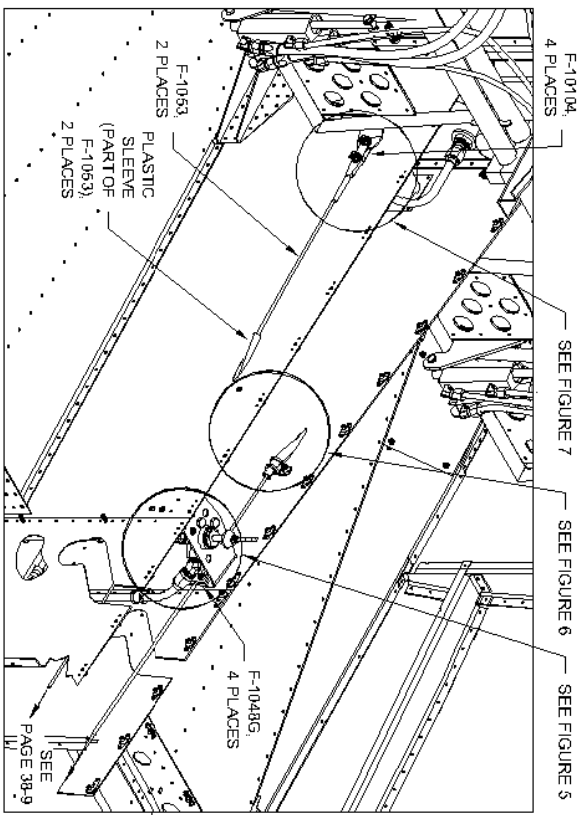

FIGURE 4: ROUTING THE RUDDER CABLES THROUGH THE FORWARD FUSELAGE

Step 3: Finish Drill #27 both F-1048G Rudder Cable Guide attach holes in the F-1049-L and -R Fwd Fuselage Ribs.

Step 4: Assemble both F-1048G Rudder Cable Guides to the F-1049-R Fwd Fuselage Rib as shown in Figure 5 using the hole match-drilled in Step 2 (place the side with the centerline drawn in Step 2 against the fwd fuselage rib). Align the centerline with the center of the remaining hole in the fwd fuselage rib then match-drill #27 this hole into both rudder cable guides.

Step 5: Remove the F-1048G Rudder Cable Guides and deburr the holes drilled in Step 3.

Step 6: Place the F-1053 Rudder Cable in the slot in-between the F-1048G Rudder Cable Guides and install the guides to the F-1049-R Fwd Fuselage Rib using the hardware called out in Figure 5.

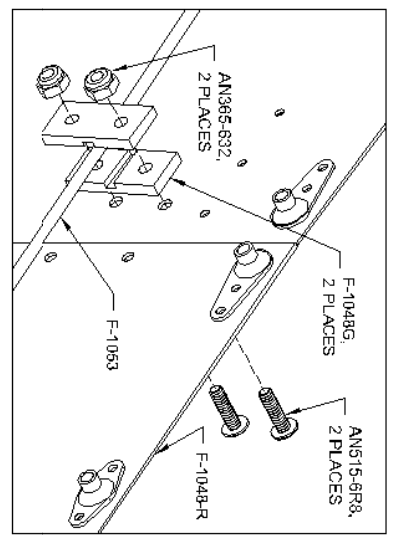

FIGURE 5: INSTALLING THE RUDDER CABLE GUIDES

Step 7: Repeat Steps 3-5 to install the remaining set of F-1048G Rudder Cable Guides to the F-1049-L Fwd Fuselage Rib.

Step 8: Clamp the forward most plastic sleeve on the F-1053 Rudder Cable to the F-1049-R Fwd Fuselage Rib using the hardware called out in Figure 6. Position the plastic sleeve so that the oval slot in the fwd fuselage rib is completely protected from the rudder cable. Repeat this step to clamp the other rudder cable to the F-1049-L Fwd Fuselage Rib.

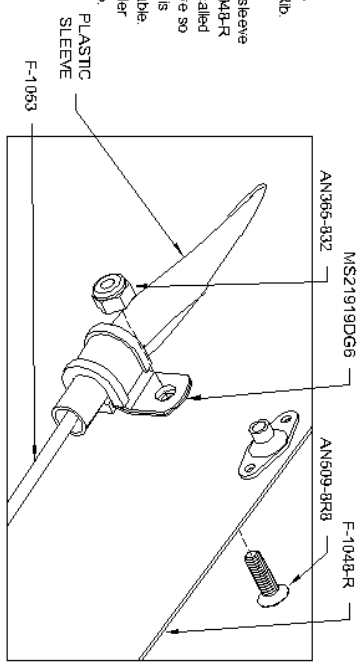

FIGURE 6: RETAINING THE PLASTIC SLEEVE

Step 9: Prime or paint the F-10104 Rudder Cable Links.

Step 10: Install the F-10104 Rudder Cable Links between the WD-1006-L and -R Rudder Pedals and the F-1053 Rudder Cables. See Figure 7.

NOTE: Bend the ends of the cotter pin into the slots in the castle nut to prevent them from catching on a shoe and unbanding.

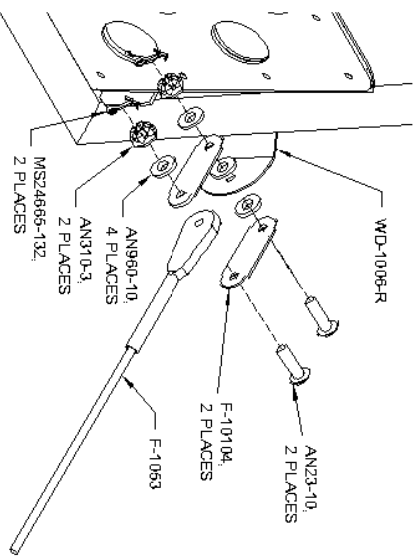

FIGURE 7: INSTALLING THE RUDDER CABLE LINKS